

GLOCAL ARCHITECTURE

INTERNATIONAL CONFERENCE &
WORKSHOPS FOR YOUNG PROFESSIONALS

www.ecoweeek-ks.org

WORKSHOP 1

Tutors:

Gezim Pacarizi / Brixhita Deda / Arnisa Kryeziu

Design an ecological house for a family of

PARTICIPANTS

Amir Zejnullahu, Art Zymberi, Dren Begolli, Emira Haxhikadrija, Egzon Islami, Fjolla Januzi, Genita Salihaj, Ibrahim Beqiri, Jeton Haxhimustafa, Korab Mahmuti, Tauran Kuqi, Vlerim Sojeva

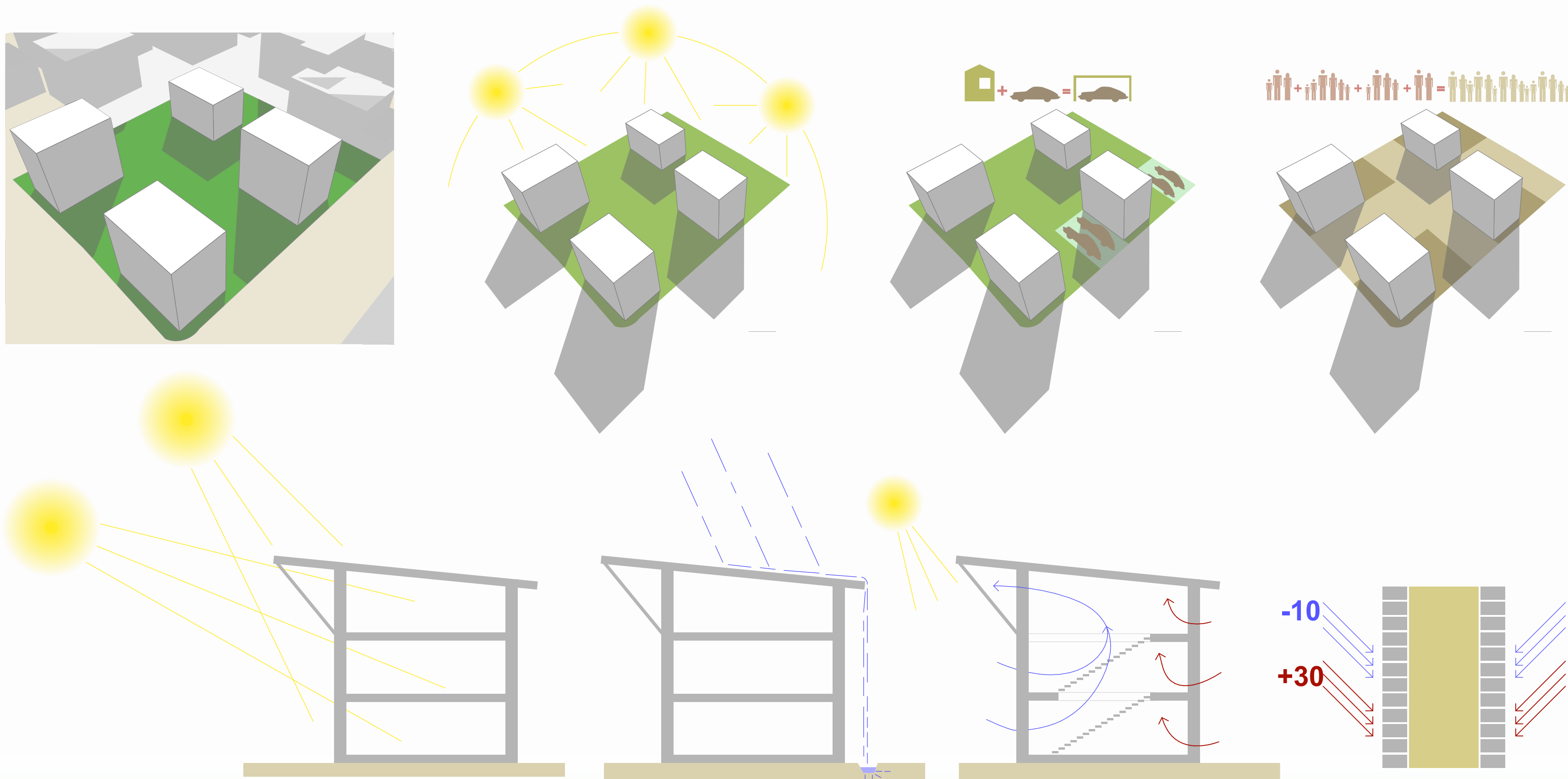
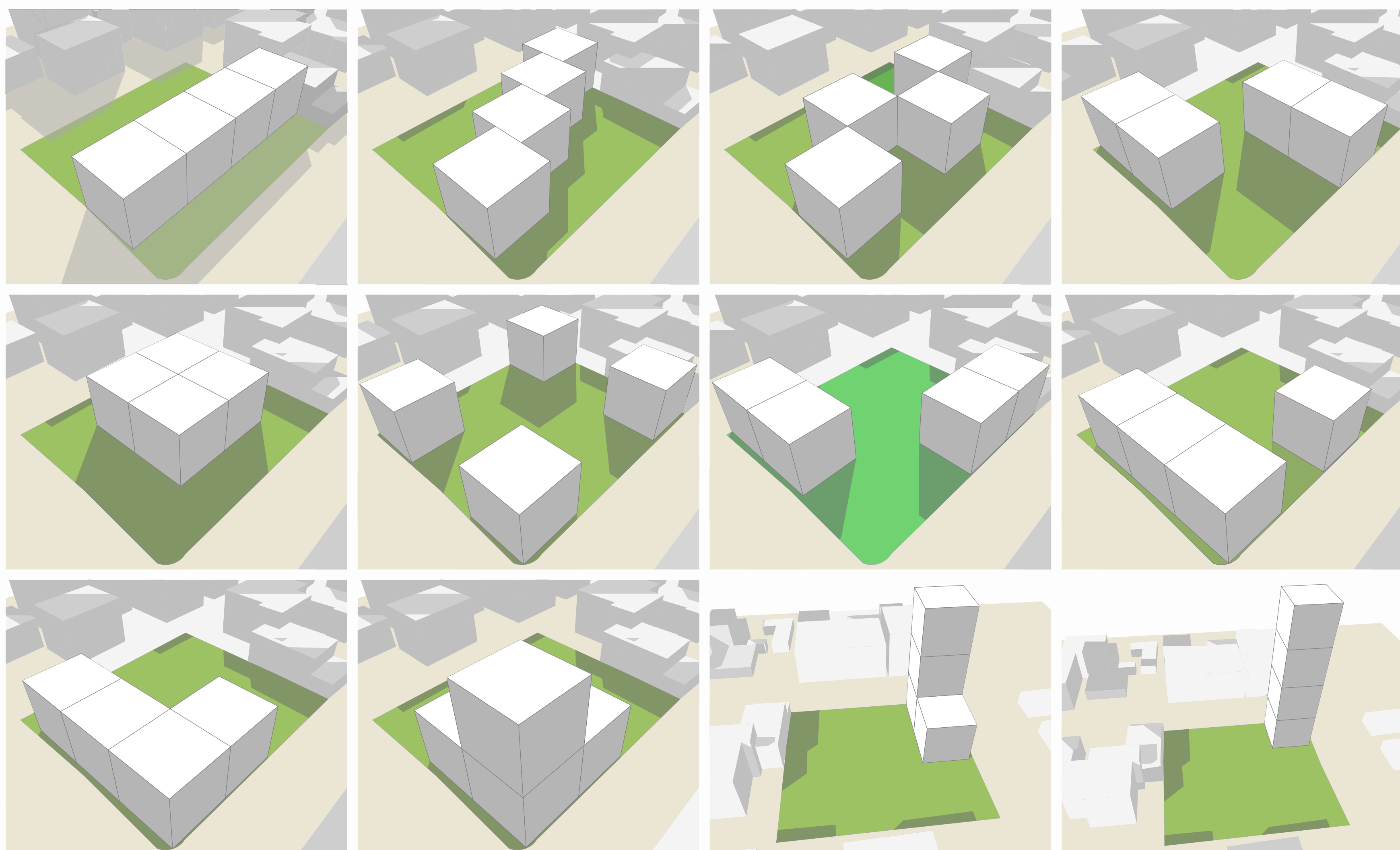

The workshop was very concentrated, within five days, a process that normally requires months or years. The work was arranged in such a way that the architectural design process would be as clear and visible as possible. The purpose of this workshop was not creativity, but the learning the process of designing step by step. So each day covered a topic, a stage of the process, a scale of architectural expression.

Topic

The project assignment was to design an ecological house: with local and natural materials that require less energy to produce - that is cheaper; small and functional spaces, compact building that have less energy loss; Houses that can be destroyed and materials can return to nature without pollution or cost. The quality of life within a qualitative architecture is the starting point for assignment. The project is based on vernacular architecture, inspired by traditional houses in Pristina, building techniques, local and natural materials,. Given this, we brought a proposal with different spatial development, inner approach and compositional elements, according to nowadays-basic family needs. The challenge was how to adapt a modern architecture to improve aesthetically, functionally, ecologically and financially an urban settlement / building performance.

Context

We chose a site plot in Pristina, but the idea is that the project can be built anywhere in Kosovo. The site plot is located in 'Lagjia e Muhaxhereve', a neighbourhood close to Pristina city center. The neighbourhood morphology is basically composed of low residential building 1-4 storey, with commercial use in the ground floor. The urban revitalization of the plot allows to create private garden for each of the houses, and to create an inner courtyard for the entire plot, to provide better accessibility.

Scenario

One of the most widespread phenomena in Kosovo is the construction of some houses identical or very similar to some brothers. We take 4 clients imaginary, 4 brothers. They have bought a land lot in Pristina. They want to build 4 houses. Each workshop group had to design a house. Based on the overall analysis (content, context, orientation) we proposed a volume of 9mx6mx6m (or 9m in height).

Ecological aspect

The houses will be designed with adequate access to these ecological aspects:

- Organizing the spaces in harmony with the natural conditions,
- Access to the heating - cooling, water drainage, ventilation
- Local materials, such as: adobe for walls; straw or chaff for insulation; wood for structural reinforcements, roof and slabs; stone for basement and underground walls.
- Building envelope houses should provide comfortable living and energy saving,
- Adequate technical details and building construction techniques, which can reduce the cost of construction.

Each building has a vertical ventilation circulation. Sloppy roofs, which are cantilevered 1 m on three sides, and 3m on the south orientation serves as a shading element during summer. The northern side of the roof, where the height is minimum, it facilitates the drainage of the rainfall to go to the ground and it distributes homogenously the water in the parcel through canals. Buildings are oriented to the south, to get the best radiation during the day. The pitched roof allows placing photovoltaic panels, which produce electrical supply for heating.