

# ECOWEEK Israel 2018

## W4 THEME: From Green Campus to Sustainable Campus at HIT

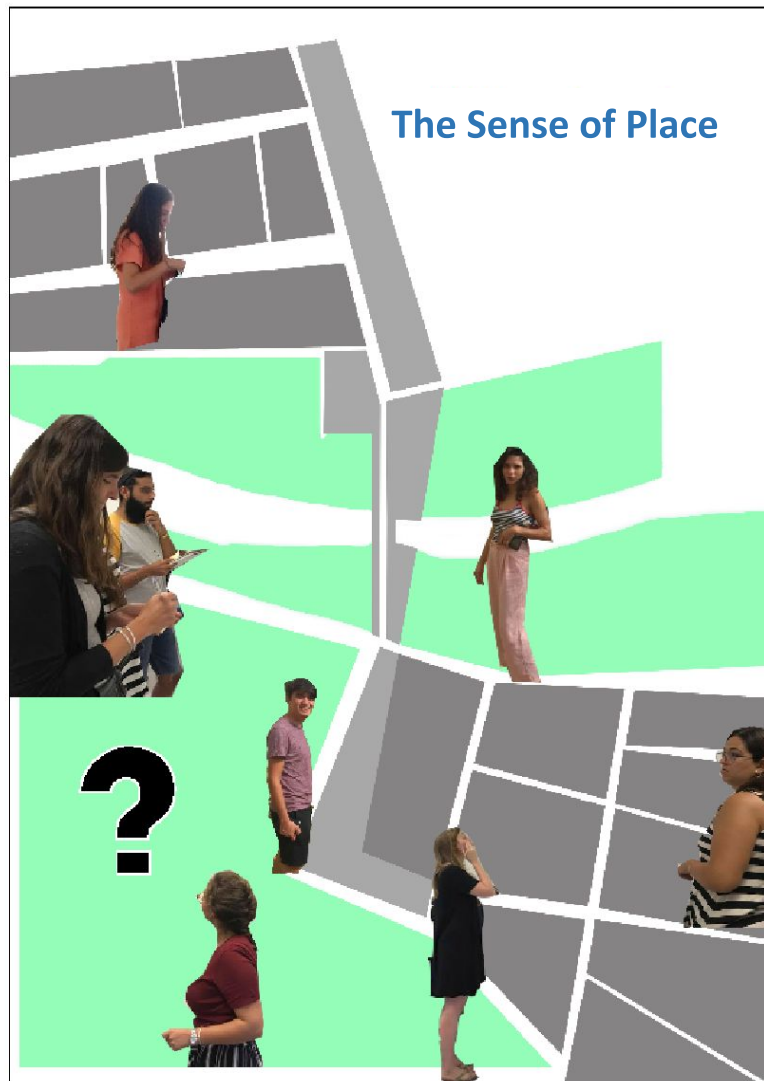



## **:Participants**

Danielle Dadon – Interior Design – Israel  
 Dor Eli - Industrial Design – Israel  
 Shir Geva - Interior Design – Israel  
 Shira Nathan – Interior Design – Israel  
 Elías José Rojas Álvarez- Architecture – Germany  
 Myriam Schueler- Architecture – Germany  
 Shir Yogev – Interior Design – Israel

## **:Workshop leaders**

Arch. Braha Kunda and Arch. Dr. Elias Messinas



Mental Map

# From Green Campus to Sustainable Campus

W4 THEME: Sustainable design in urban spaces

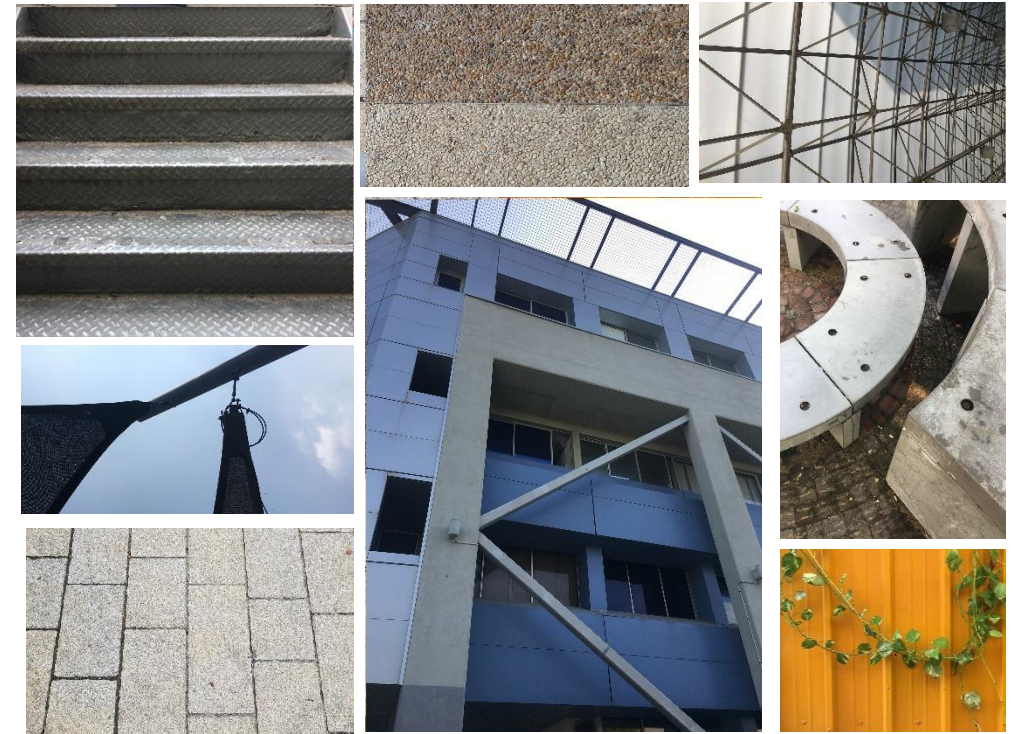

# Site Current Situation

## W4 THEME: From Green Campus to Sustainable Campus at HIT

## HIT VISION - MACRO

- To remain an outstanding and **multidisciplinary** academic institution with a **scientific**, **technological** and **design** orientation
- To remain a **leading academic institution**, thriving towards the development and advancement of the
- **hi-tech industry**
- Providing up-to-date knowledge, good civic values, social and environmental responsibilities
- To influence the academia in Israel and abroad



# Project background | Communities

W4 THEME: From Green Campus to Sustainable Campus at HIT



### Computer Science Students

- 4 days a week
- whole day
- lunch break 13:00 - 14:00
- library, computerlab



### Technology & Science Faculty



### Design Faculty



### Management Administrative Faculty

- vision to advance technological interest
- achieve sustainable improvement
- create young, dynamic, sustainable environment



### Design Students

- 4-6 days a week
- whole day
- lunch break 13:00 - 14:00
- sitting in groups (grass area)
- Creative

# Project background | Communities

**W4 THEME: From Green Campus to Sustainable Campus at HIT**

Soft surface & Vegetation



Noise



## SENSE SCHEMES

# Project background: Site Evaluation

W4 THEME: From Green Campus to Sustainable Campus at HIT

Hard surface



Smell



## SENSE SCHEMES

# Project background: Site Evaluation

W4 THEME: From Green Campus to Sustainable Campus at HIT

# Climatic Comfort

March

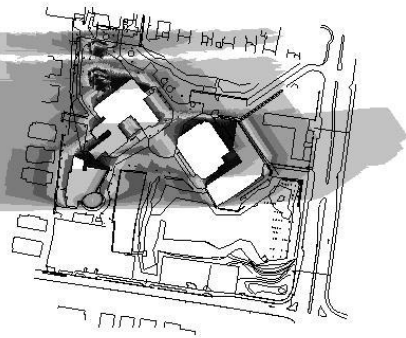

September

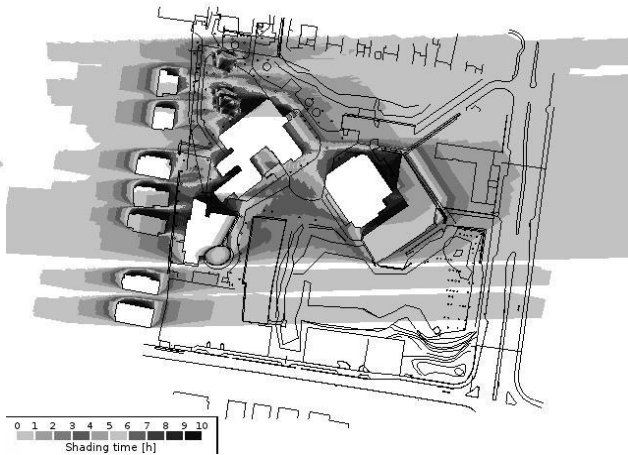

June

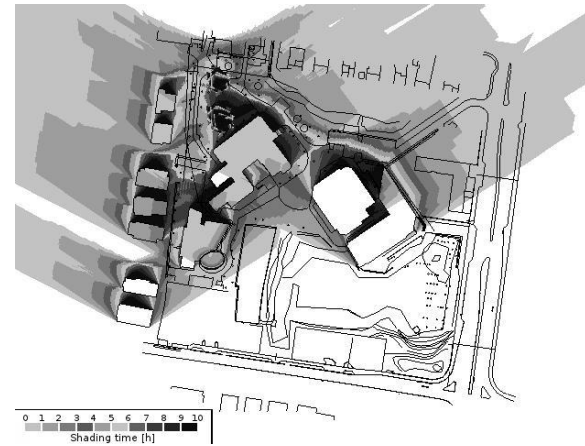

December

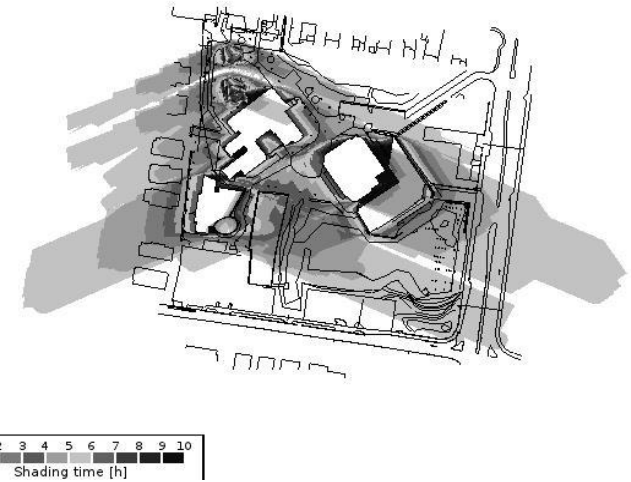

## Shadow Analysis | campus map

W4 THEME: From Green Campus to Sustainable Campus at HIT

**ECOWEEK**  
... habits change ... climate change

**HIT**  
מכון טכנולוגי חולון  
Holon Institute of Technology

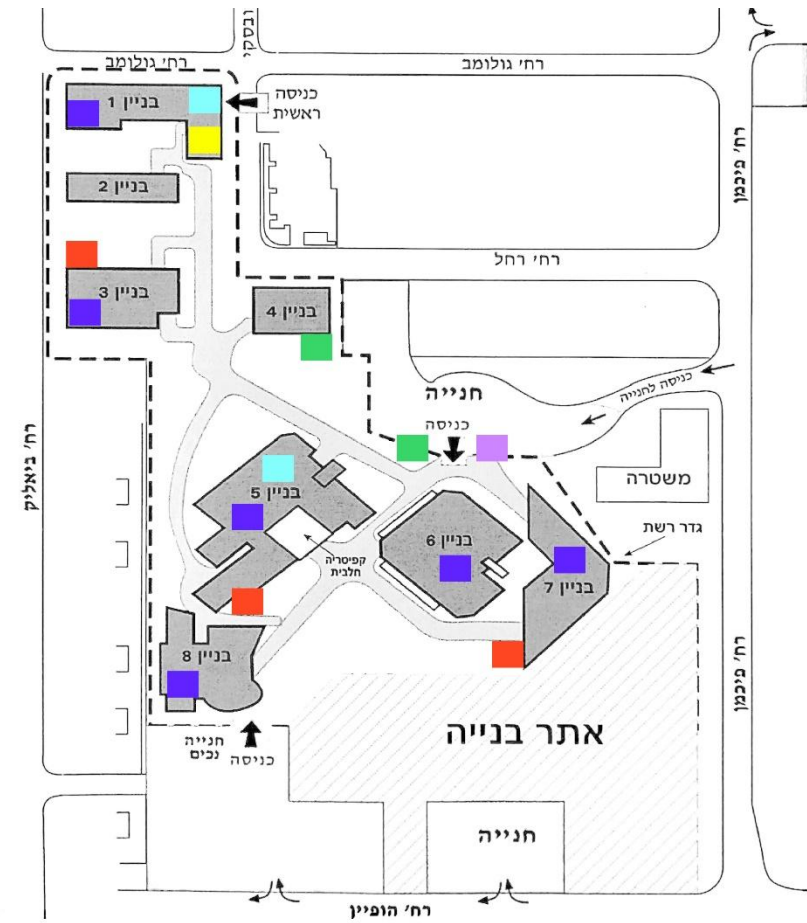

- Legend
- Bottles
  - Materials and electronic equipment
  - Medicine
  - Glass
  - Paper and cardboard
  - Batteries
  - Solar Panel for charging cell phones

?Randomly placed bins: How may they be arranged to array environmental consciousness

## **:Goals and Objectives**

- o **Create Living Places** to meet, refresh, learn
- o Transform from 'Green Campus' to 'Sustainable Campus'
- o Raise awareness to ECO-HUMAN environmental aspects
- o Change Behavior in relation to material consumption



reduce.  
reuse.  
recycle.



## **: Micro-Macro Process Guidelines to Sustainable Design and Development**

- o Collaboration and participation of the various stake-holders and players
- o Sensing, Observing and evaluating physical and Human context
- o Design for Social Interaction - sharing and participation
- o Holistic, Integrative Eco-Human Centered and multidisciplinary design

# **Design Brief and Principles**

**W4 THEME: From Green Campus to Sustainable Campus at HIT**

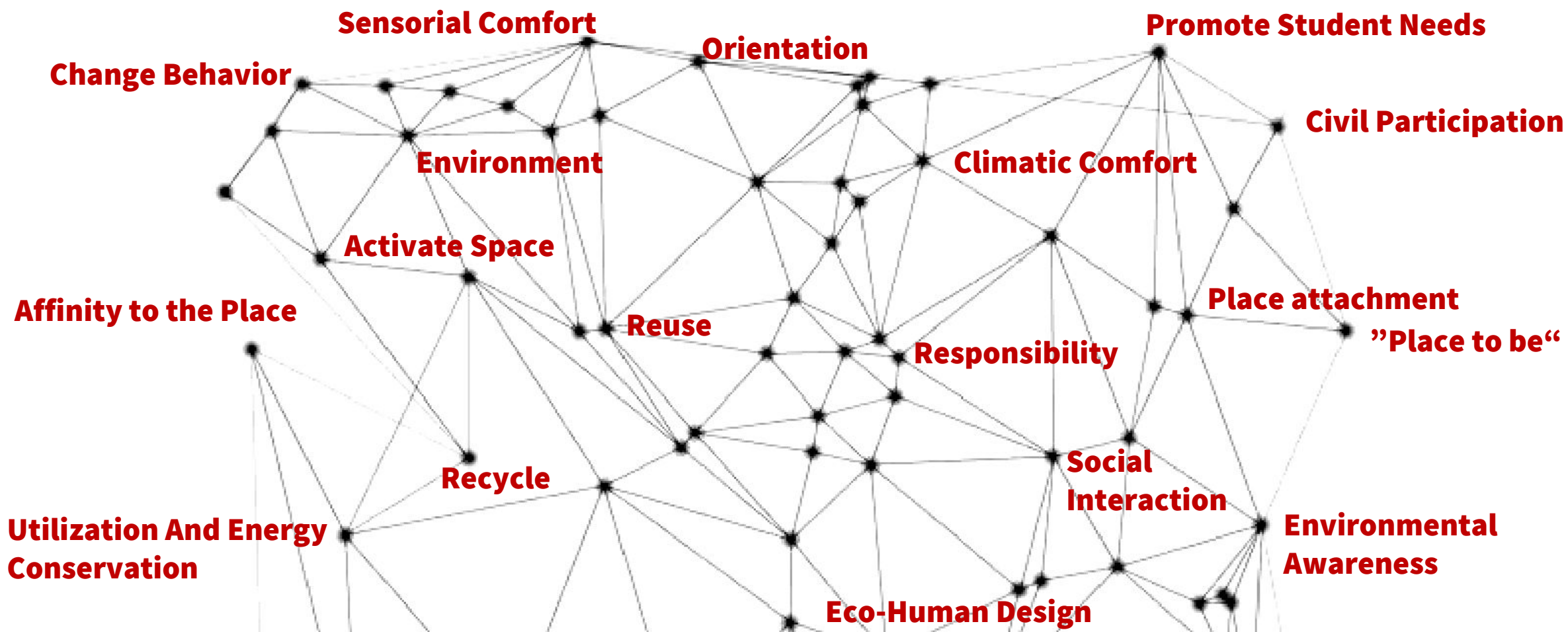

# Vision & Values

W4 THEME: From Green Campus to Sustainable Campus at HIT

Create a place that will be pleasant to meet especially learning "in a green environment" Develops Green campus into a sustainable campus

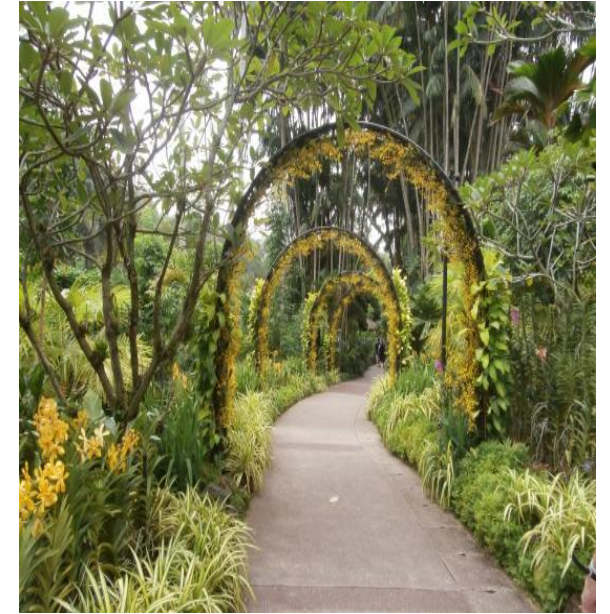

# Inspirations | Botanical Gardens, Kibbutz

W4 THEME: From Green Campus to Sustainable Campus at HIT

**HIT**  
מכון טכנולוגי חולון  
Holon Institute of Technology

**ECOWEEK**  
... habits change ... climate change

## Concepts For Intervention | Eco - Puncture

?How to create a confined place for learning | meeting | resting

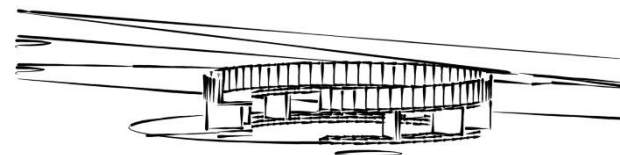

# Circles | Micro-climatic intervention

W4 THEME: From Green Campus to Sustainable Campus at HIT



# Landscape room | Trees, Hedges, wooden element

W4 THEME: From Green Campus to Sustainable Campus at HIT

**Hit**  
מכון טכנולוגי חולון  
Holon Institute of Technology

**ECOWEEK**  
... habits change ... climate change

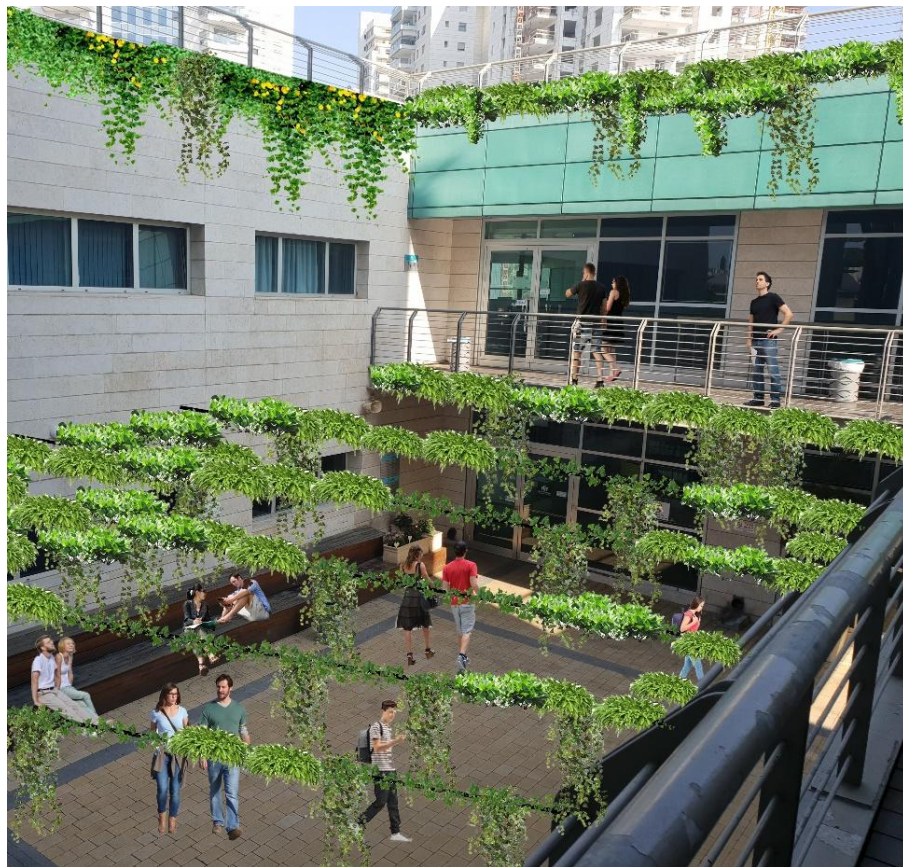

# Microclimate Garden | Inner court #6 - #7

W4 THEME: From Green Campus to Sustainable Campus at HIT

**HIT**  
מכון טכנולוגי חולון  
Holon Institute of Technology

**ECOWEEK**  
... habits change ... climate change



EcoWeek 2017, Enosh



# Therapeutic Garden | Accessibility Center #8

W4 THEME: From Green Campus to Sustainable Campus at HIT

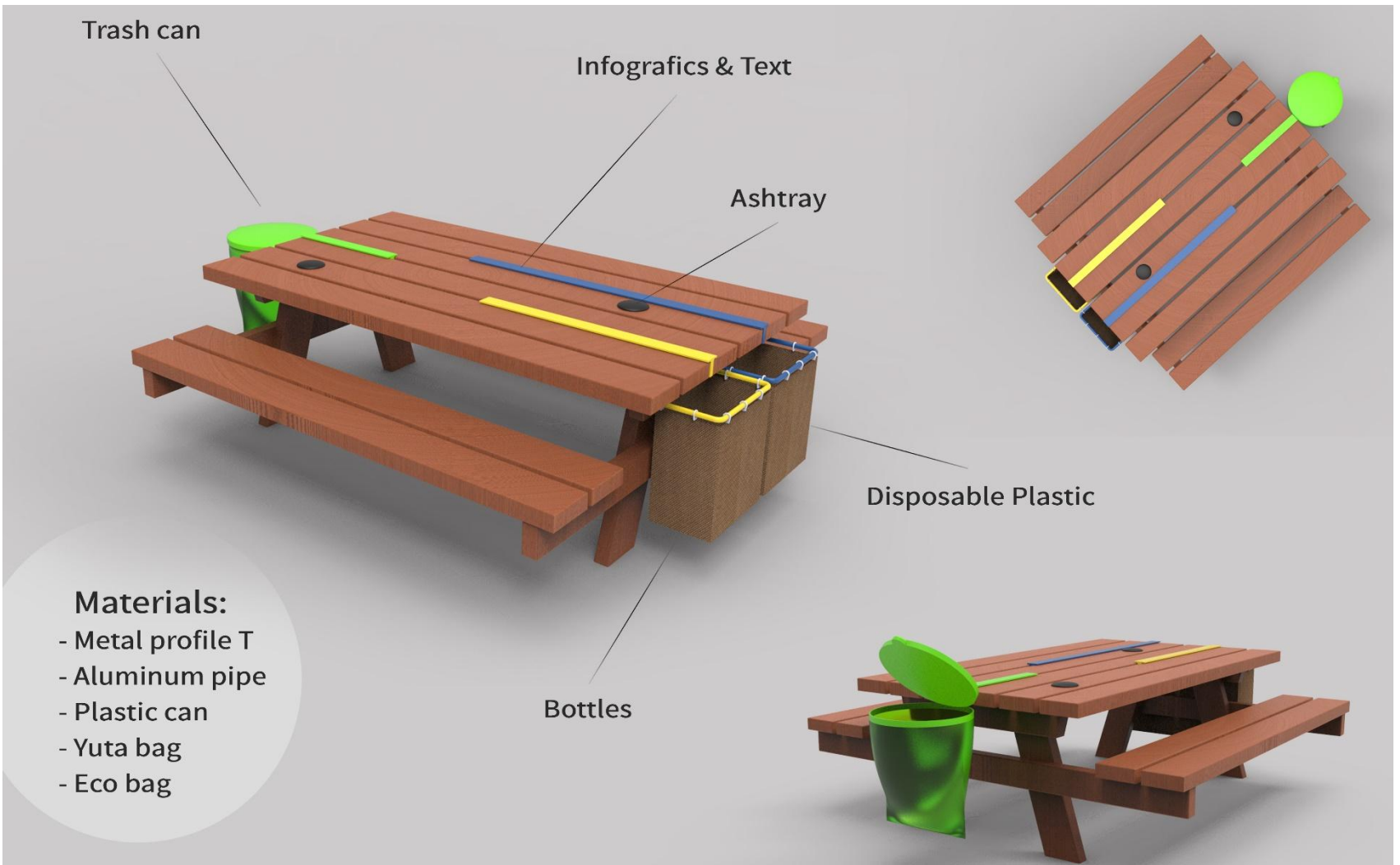

# Recycling Add-On | KKL Table, collect trash on spot

W4 THEME: From Green Campus to Sustainable Campus at HIT



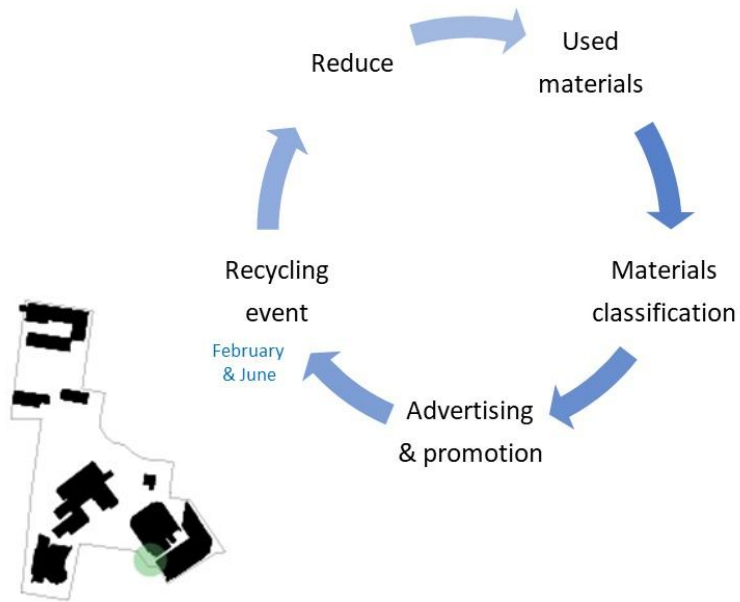

# Reuse to Reduce

Circular use of materials in the Design Faculty

**W4 THEME: From Green Campus to Sustainable Campus at HIT**

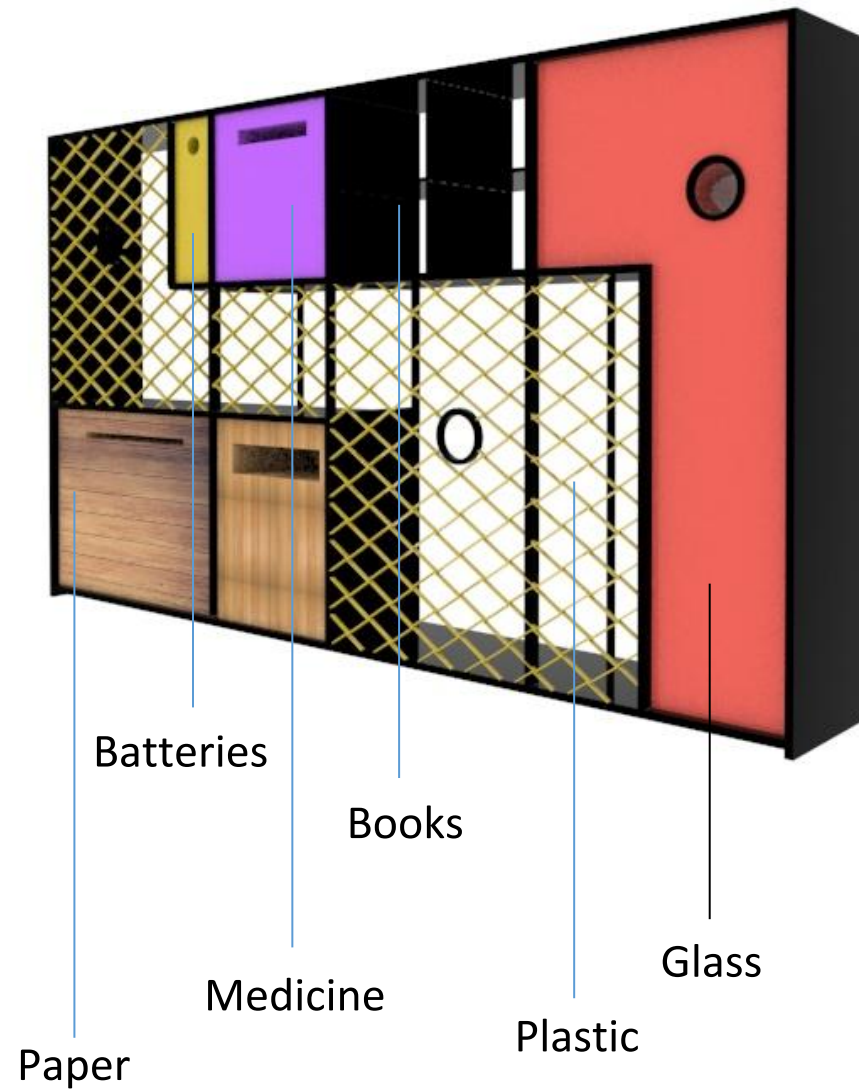

# Recycling facility | Creating a place & raising awareness

W4 THEME: From Green Campus to Sustainable Campus at HIT

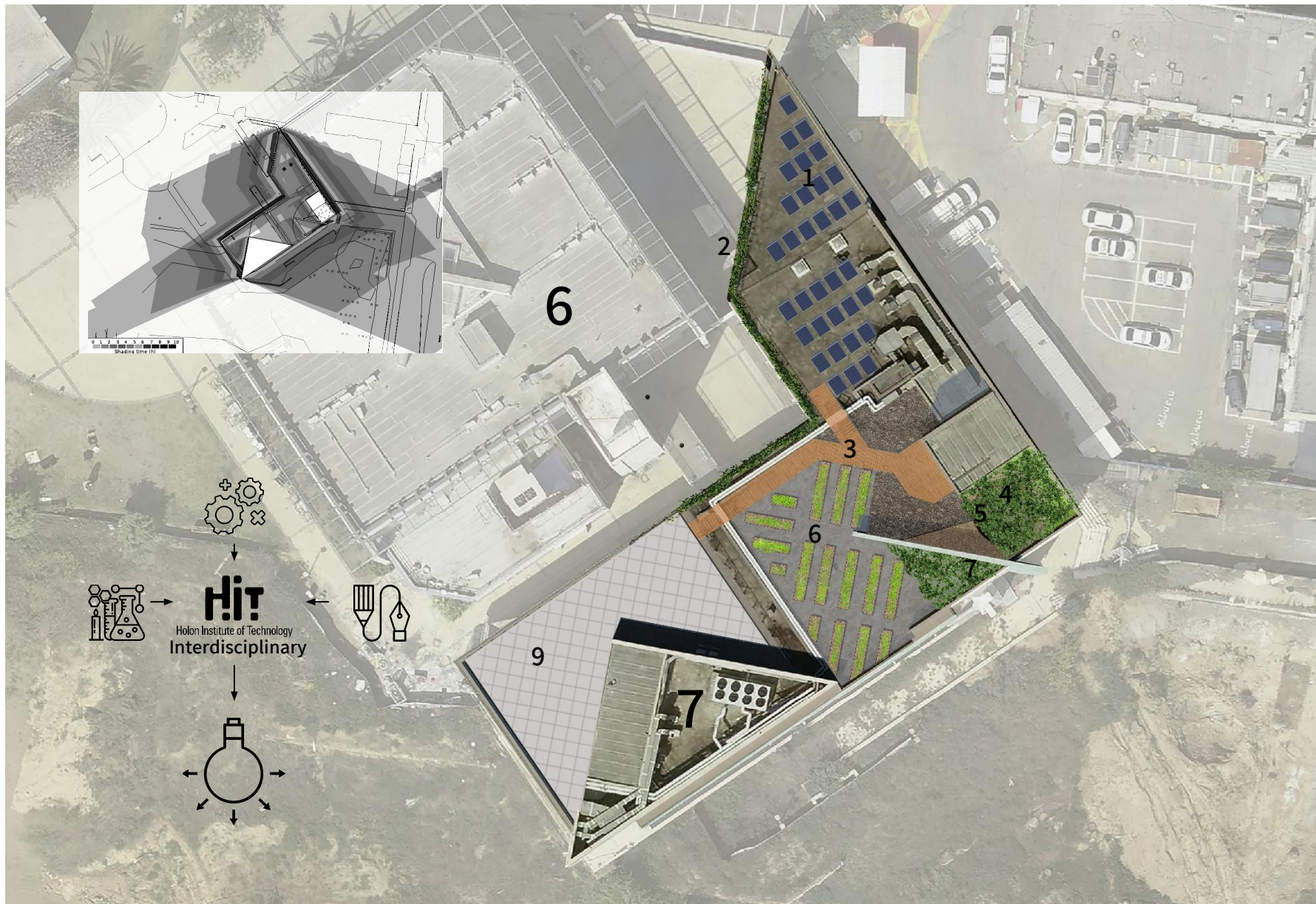

Robotics      Landscape  
Technology      Learning  
Innovation      Demonstration

## :Components

- 1      Solar panels
- 2      Vertical vegetation
- 3      Wooden runway
- 4      Vegetal shading
- 5      Outdoor classroom
- 6      Urban agriculture
- 7      Storage
- 8      Working places
- 9      Special events





Vegetal shading

Vertical vegetation

Upper plants terrace

Lower plants terrace

Seating circle

Wooden structure

Vegetal ground cover



Micro-Climature

Add-Ons

Eco Innovation

Nature

**|E-Collaboration**

W4 THEME: From Green Campus to Sustainable Campus at HIT

Accelerator Research & Development  
Lab for Urban Agriculture

Summoning  
**HIT**  
מכון טכנולוגי חולון  
Holon Institute of Technology

**ECOWEEK**  
... habits change ... climate change

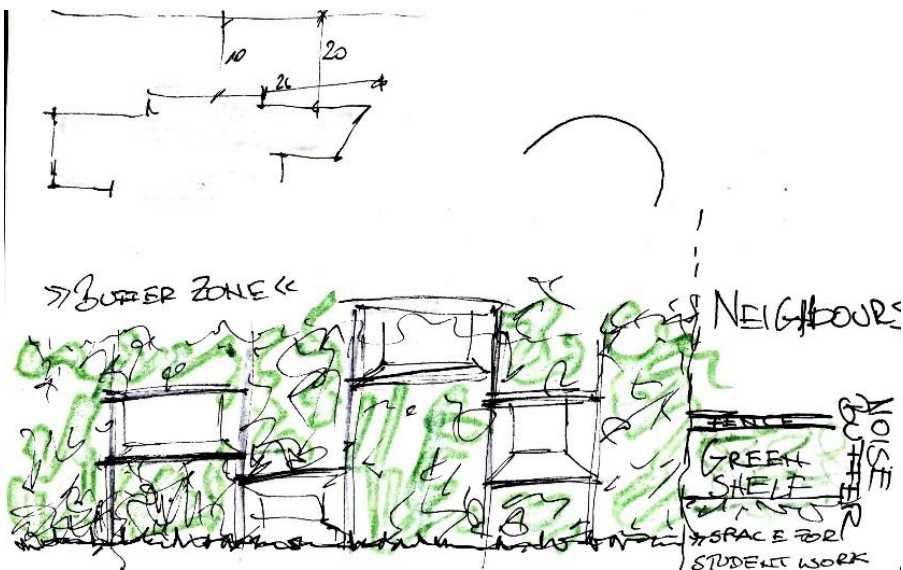
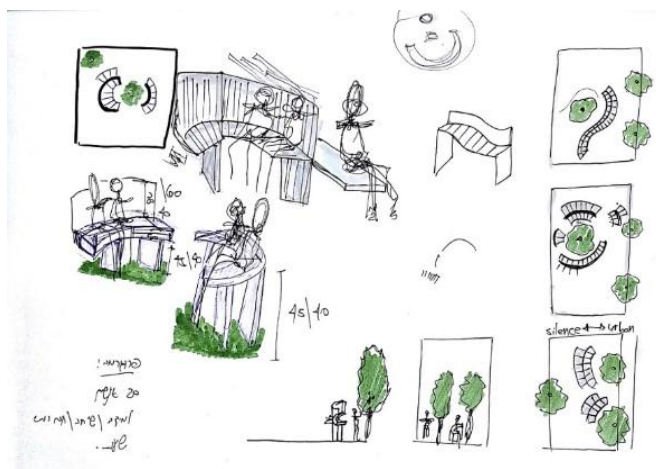
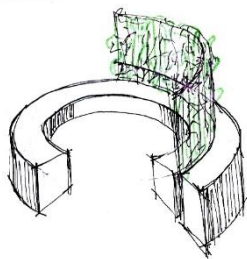
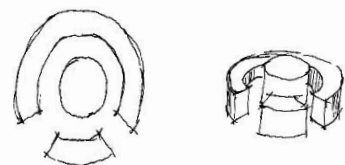
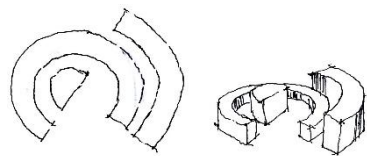
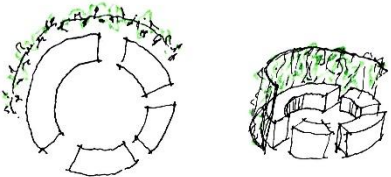
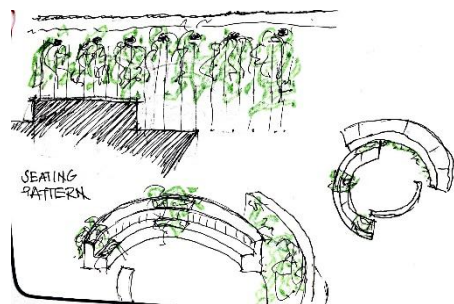

# Sketches | Concept development

W4 THEME: From Green Campus to Sustainable Campus at HIT

”!If it’s not fun it’s not sustainable“