

W1 – MAD(A) ECOVILLAGE – ECOWEEK MILAN 2011





ANDREVO
VILLAGE



LOCALIZATION

SOCIAL



TOURISTS ANDREVO

DEVELOPMENT of LOCAL PEOPLE

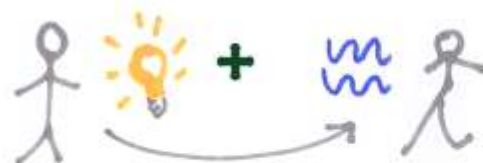

PRODUCTION of ENERGY & WATER



TOURISTS

MONEY

REINVESTMENT in SOCIAL PROJECTS

SITE



WATER



ANIMALS



AGRICULTURE



LOCAL PEOPLE



SUN



TOURISTS

ENERGY



ORGANIC WASTE



SOLAR WATER HEATER



PHOTOVOLTAIC



RECYCLING



RAIN WATER



CONSTRUCTED WETLANDS

MAD(A) ECOVILLAGE

PROMOTER



ADOPTED TECHNOLOGIES

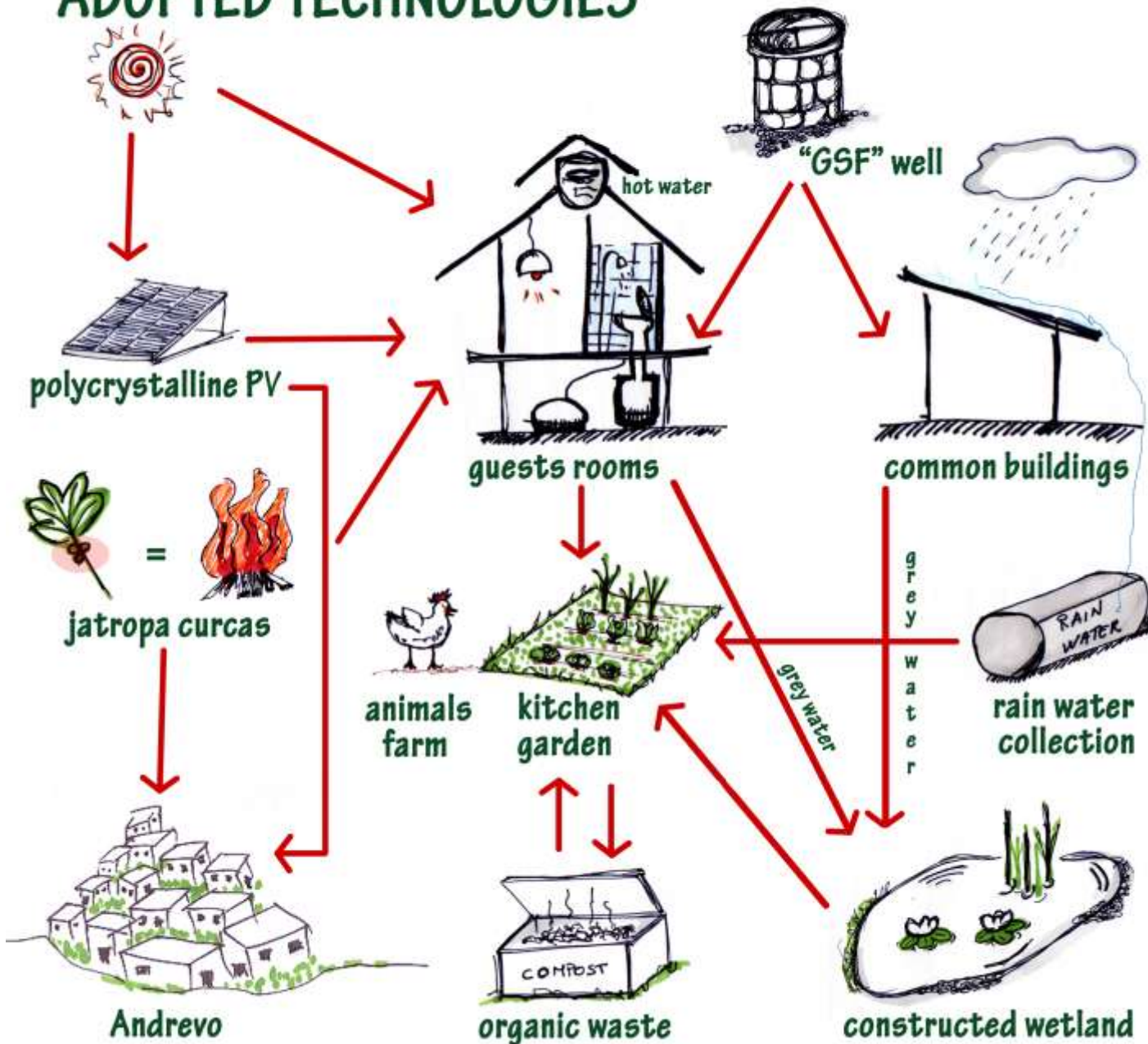

SITE:
ANDREVO, TOLIARY RURAL
(MADAGASCAR)

AREA SURFACE : 4.3 HA

ELEVATION:
FROM 0.0 TO 2.0 A.M.S.L.

GEOGRAPHICAL COORDINATES :
- LAT 23° 2' 0" SOUTH
- LONG 43° 33' 0" EAST

CLIMATE :



MAD(A) ECO VILLAGE:
GUEST - 80 PERSONS

STAFF - 35 PERSONS

POWER NEED - 40.000 KWH

SUN POWER PRODUCTION - 60 KW

CONSTRUCTED WETLAND PLANTS :
RHAMNUS, IRIS, NYMPHEA, BAMBOO,
CHHORNIA CRASSIPES, SALVINIA,
JUNCUS

STRUCTURE PLANTS :
RAVINALA, BAMBOO

ROOF:
RATY (RAVINALA'S DRY LEAVES)

CURTAIN WALL:
BAMBOO,
CLAY WALL,
ZOZORO (PAPER STALK)

SOME REALIZED PROJECTS



MALI



TOGO



MAD(A) ECOVILLAGE ESTIMATED COSTS

BUILDINGS:

GUEST AND STAFF BUILDINGS _____	700.000 €
RESTAURANT _____	160.000 €
DIVING CENTER _____	125.000 €
HARBOUR _____	5.000 €

TOT 1.801.000 €

TECHNOLOGIC SYSTEM:

-PHOTOVOLTAIC SYSTEM _____	260.000 €
-WELL DRILLING, WATERPIPES INSTALLATION, WATER WELL CLEANING, PUMP TESTS, PUMPS INSTALLATION _____	40.000 €
-2 SOLAR PUMPS+SOLAR PANELS _____	16.000 €
-WATER TANK (FOR RAIN WATER COLLECTION) 100 LT CAPACITY _____	8.000 €
- WATER PUMP FOR WATER TANK _____	3.000 €
-WATER DISTRIBUTION SYSTEM _____	20.000 €
- TOILETS _____	142.000 €
-CONSTRUCTED WET LAND _____	6.000 €
-GENERATOR _____	6.000 €
-KITCHEN _____	10.000 €

OTHERS:

-UNEXPECTED THINKS _____	20.000 €
- LAND RENT FOR 90 YEARS _____	180.000 €

MAD(A) ECOVILLAGE



MASTERPLAN

PHOTOVOLTAIC PARK &
ENERGY AREA

ANIMALS FARM &
KITCHEN GARDEN

STAFF
ROOMS

GUESTS
ROOMS

CONSTRUCTED
WETLAND

RECEPTION

HARBOUR

RESTAURANT - BAR &
DIVING CENTER





Guest-room



Staff-room

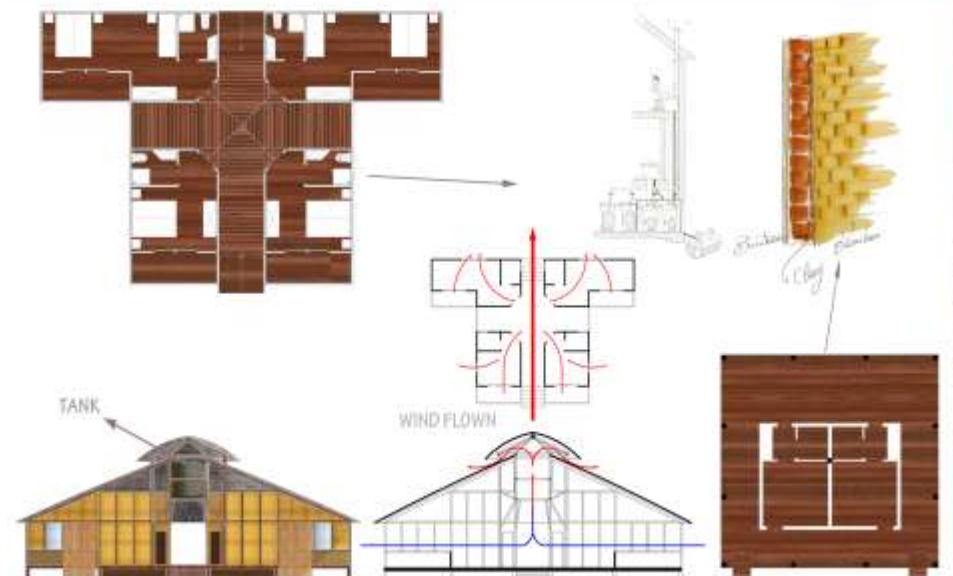



floor plan



brick wall details



construction details

Reception

leisure facilities



roof structure details



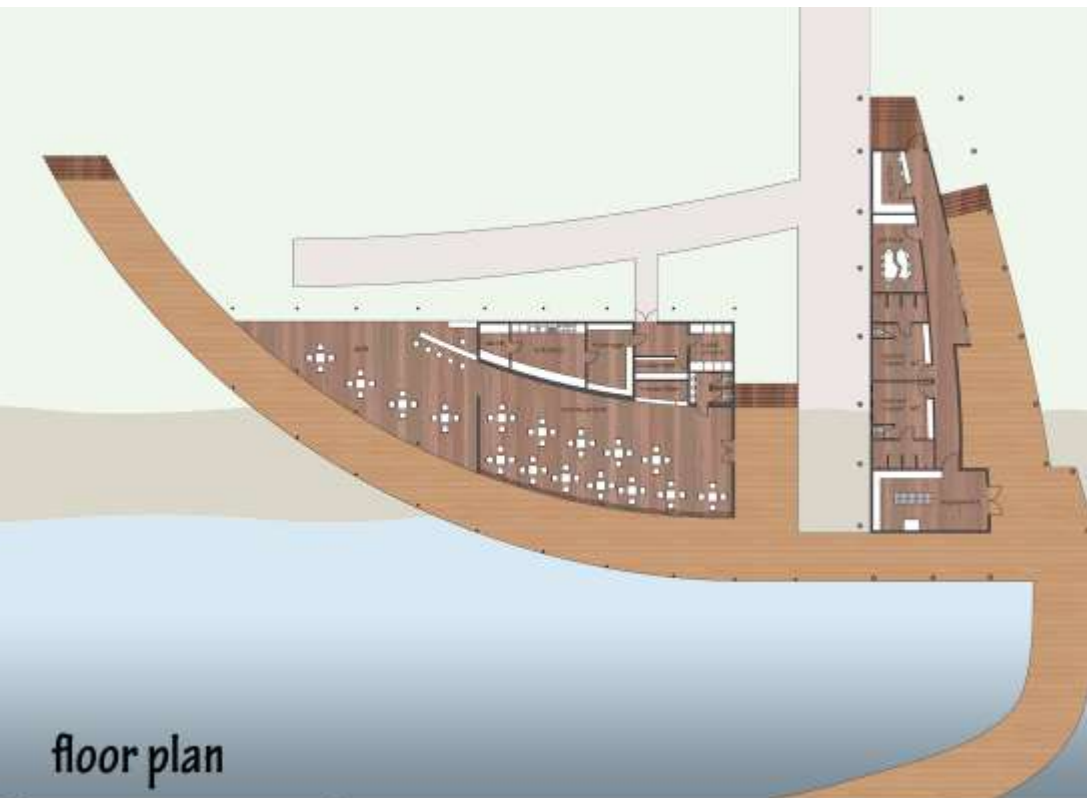

floor plan

Diving center and Restaurant
leisure facilities

elevation



diving center

roof details

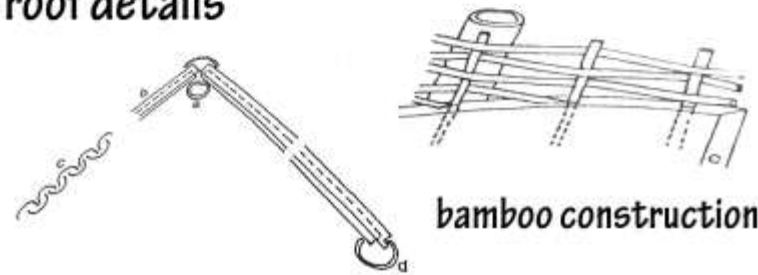

bamboo construction

seafront



ECOWEEK MILANO-2011
W1 - MAD(A) ECOVILLAGE

WORKSHOP LEADERS:

MARTA BRAVI (Gsf ITALIA)

ELISA EVASO , LUCA GUGLIERI, GIUDITTA DE VECCHI (MONOSTUDIO) - RICCARDO PAPA

WORKSHOP TEAM:

CONCETTA CICCHETTI

LUCIA DI GREGORIO

JAKUB LEON DZIEDZIC

ALEXANDRA KOZA

ILARIA MARIA LEONARDI

SARA PIROLA

KYRIAKI TOUMANIDOU