

„Evidence shows that a simple view of nature can radically improve health outcomes, so why couldn't we design a hospital where every patient had a window with a view? **Simple sight-specific designs can make a hospital that heals!**”

(Michael Murphy, *Architecture that's built to heal*)

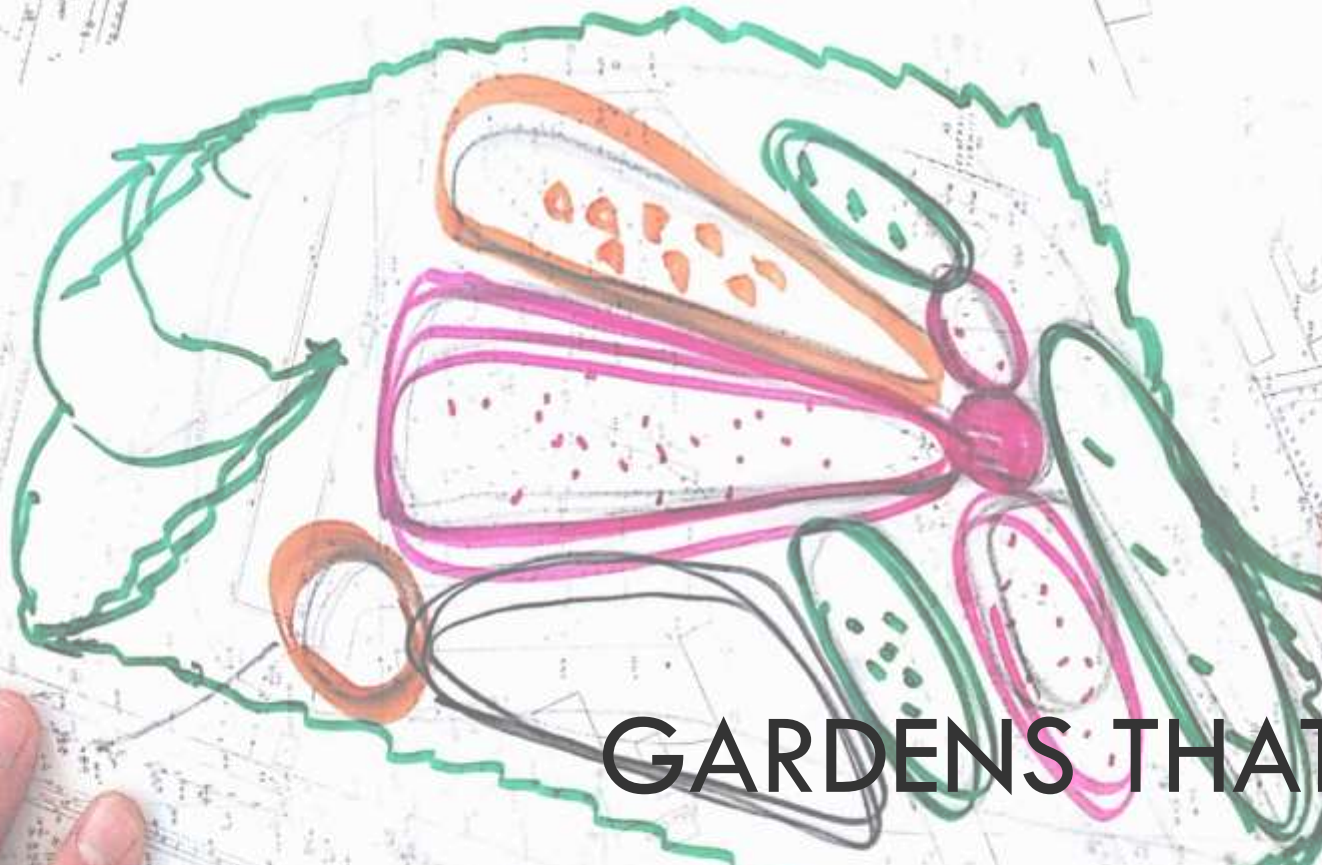

GARDENS THAT HEAL

“ THE HEALING POWER OF A WINDOW FRAME ”

Analysis

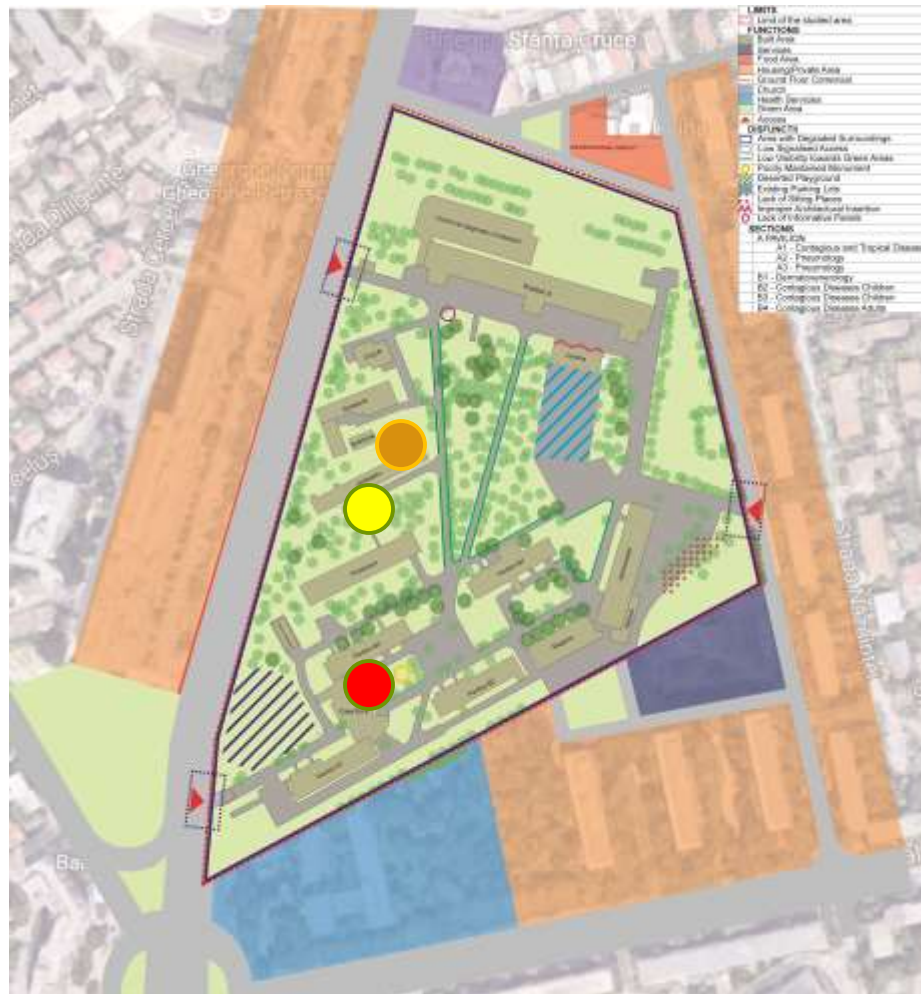
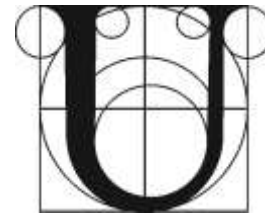

Interventions

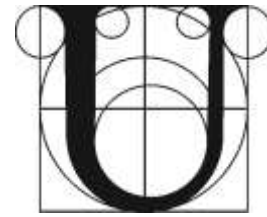

Functional zoning

ZONIFICATION

Healing gardens:

- 1. Central area** – scenographic lights and installations (visibility for the first half of the A Pavillion)
- 2. Food court** – coating of the old volume: the tree of life (visibility for the second half of the A Pavillion)
- 3. Children area** – kinetic sculptures, falling water, dressed-up trees (visibility and access from Doru House, children with HIV)
- 4. Four seasons garden** – colour therapy and plants which offer a dynamic chromatic over time (visibility for the children pavillions – B1, B2)

Leasure areas:

- 1. The student area**
- 2. The back of the food court**
- 3. Monument area** (visibility for pavillions B3, B4, Casa Doru)
- 4. Small plaza near the Casa Doru monument** (visibility for pavillions B3, B4)
- 5. Employees area**, near the second amphitheatre

Interventions

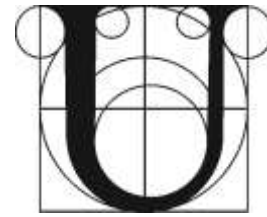

At a functional level, the proposal seeks to provide each of the 7 pavillions existing on the site with a good visibility to a natural area designed so that it would inhance spiritual healing for the patients. Thus, the solution consists in a collection of small gardens, each of them having a different personality depending on their location, more precisely on the specific of the pavillions they relate to and the needs of those hospitalized.

”Design directs perception through space. Therapy guides healing over time. Therapeutic design is the guidance of healing through space and time”
(Marni Barnes)

Interventions - lightning

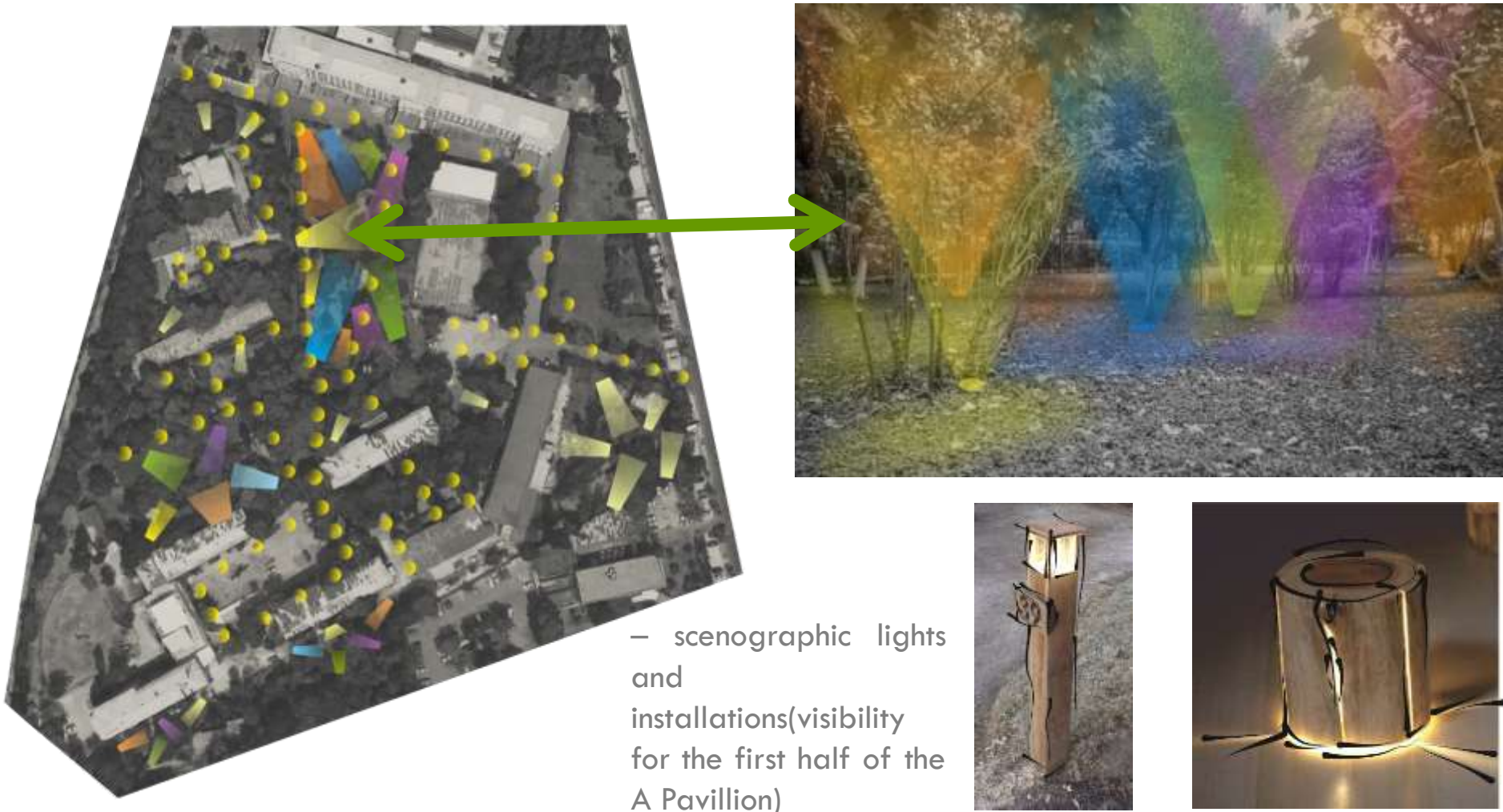
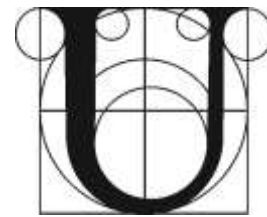

– scenographic lights and installations (visibility for the first half of the A Pavillion)



Interventions

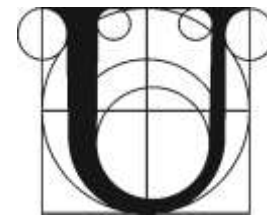

1. Central Area

Rhythm- scenery – light – movements



2. Food Court & Parking

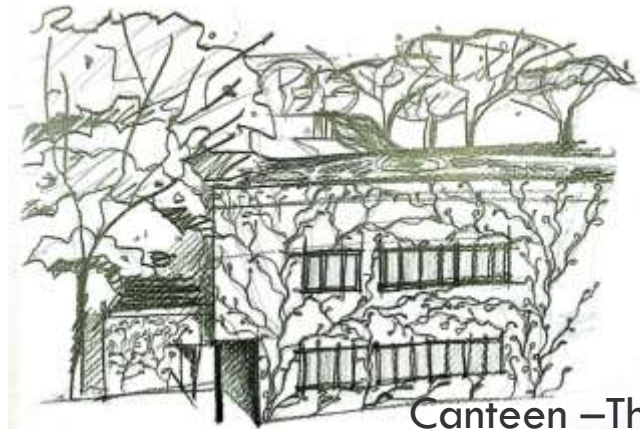

Canteen – The tree of life



Parking area - pergolas

Interventions

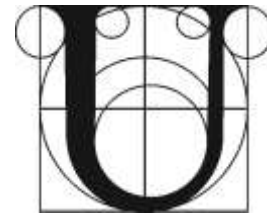

4. Four seasons garden – Healing colour

–colour therapy and plants which offer a dynamic chromatic over time (visibility for the children pavillions – B1, B2)

‘The generic name for sage, *Salvia*, comes from the latin word meaning “to heal”. The species name, *officinalis*, means that it is the species that was considered “official” for us in medicine. Since ancient time, sage has been believed to promote longevity.’

The image displays a collection of medicinal plants and garden plans. On the left, a vertical list of plant names is accompanied by circular photographs of each plant. The plants are categorized as follows:

- Stimulation of the immunity system:** Magnolia tomentosissima, Albiza julibrissin, Sorbus domestica, Camellia, Ricinus communis.
- Dermatovenerology:** Callunetum vitifolium, Phacelia, Junonia serotina.
- Contagious Diseases:** Rosa rugosa, Salvia officinalis, Echinacea, Hedera, Wisteria.
- Contagious Diseases Gastrointestinal Diseases:** Sida (Panicum), Phlox, Hibiscus, Lavandula angustifolia, Syringa vulgaris, Ceras alba.

On the right, three circular site plans are labeled: 'Dermatovenerology', 'Contagious Diseases Children', and 'Gastrointestinal Diseases'. Below these is a landscape sketch showing a person walking through a garden with a large, stylized green plant. At the bottom right is a perspective rendering of the garden area, showing a paved walkway, various plants, and a building facade with a large '10' logo.

Interventions – leisure area

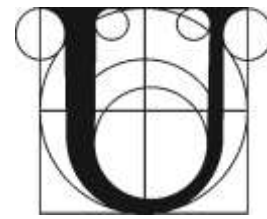

LEISURE AREA

STUDENTS SITTING
AREA



Employees
designed area

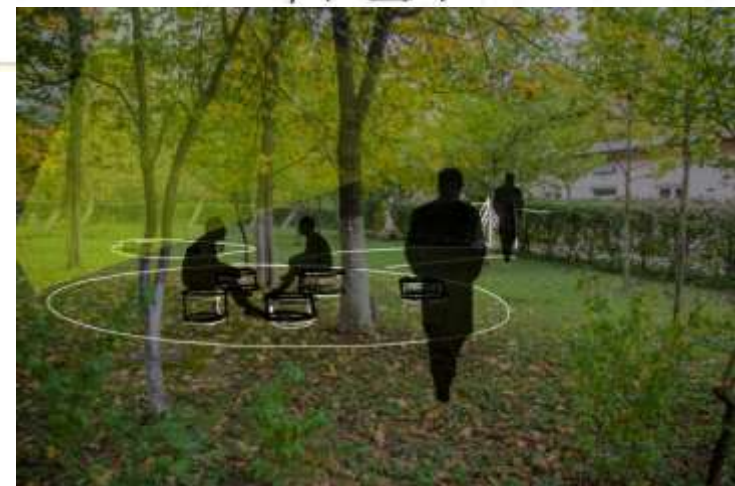

Thank you!

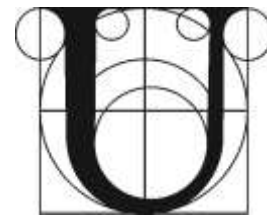

Students Alina Stefan
Anca Costan
Ana-Maria Matei
Alexandra Mera
Alexandru Ion
Andreea Andrei
Andreea Iordache
Bianca Dungeanu
Codrut Papina
Ioana Rosioru

Stefan Coinea
Valentin Clapan
Marius Istrate
Luiza Spiridon
COORDINATORS
Lands. urb. Tamara
Roseti phdc
Lands. Urb. Raluca Duica phdc
Arch. Cerasella Craciun phd

