



JERICO VALLEY JORDAN

EcoME



Aim:

Creation of a model of environmental, social and personal sustainability.



Challenges:

- Heat
- Dust
- Humidity
- Lack of Electricity
- Water Shortage
- Mosquitoes
- Noise
- Privacy
- Safety
- Financial Support
- Political Sensitivity
- Energy
- Self Sufficiency



kitchen

energy bio

water

biological
nutrients

wetland

garden

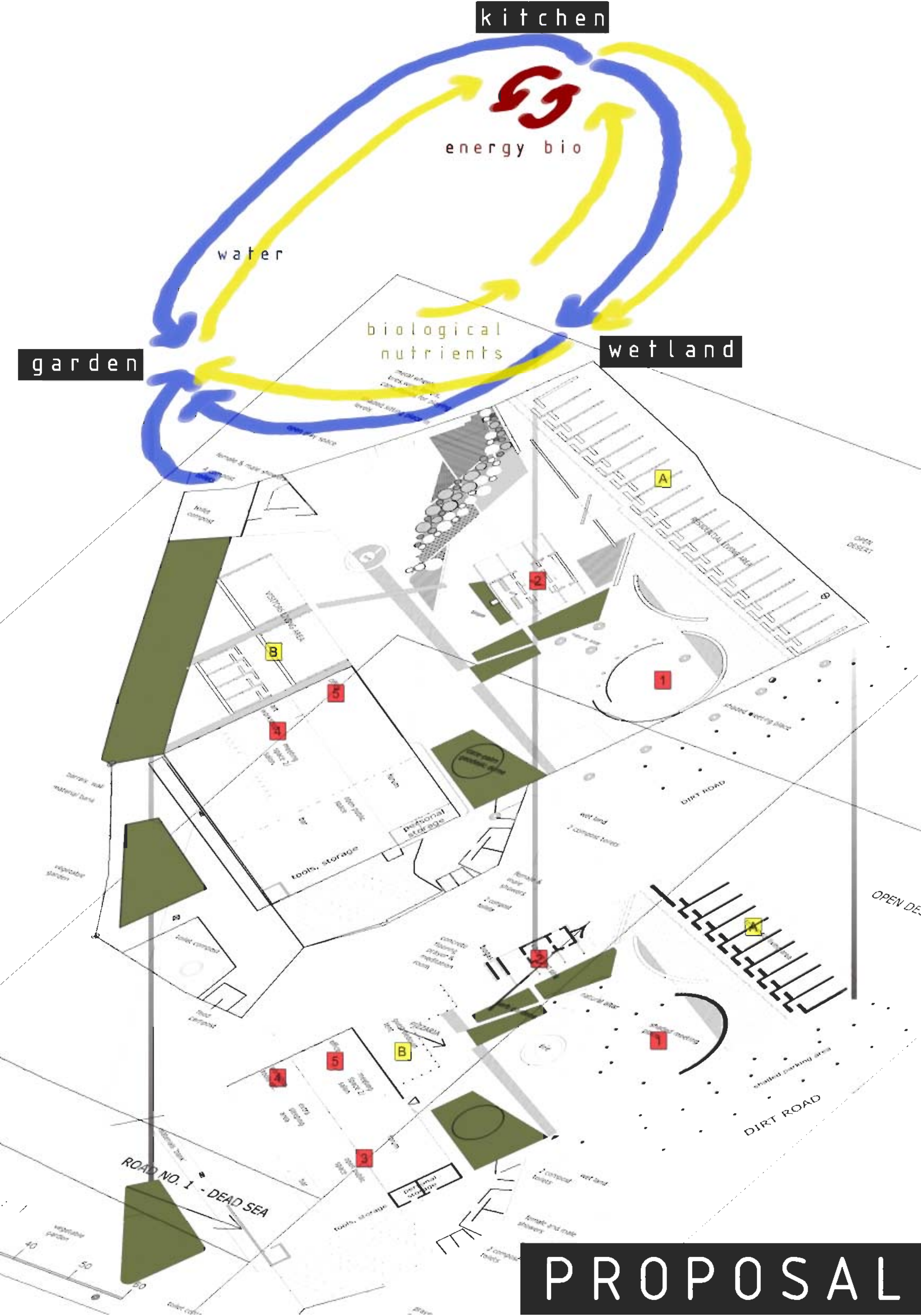

PROPOSAL

roof providing shade. angled to allow winter sun penetration and obstruct entry from summer sun. solar panels catch, collect and utilise this energy

ENVIRONMENTAL ISSUES

gauze fabric connected to roof. it's feet slightly dip into a ditch which is fed water by the irrigation system. thus, with breeze, encouraging cool air

corrugated iron roof reflecting harsh rays. slight inclination collects rain water through a pipe between rocks in the gabion walls and into the underground irrigation system

rocks within the gabion wall absorb the heat and provide small areas of shade. small, natural holes welcome the circulation of air to travel into the living area

movable bedouin tent provides insulation, shade, deflects rain, and allows a view to the sky

gabion walls provide privacy while allowing circulation and ventilation of fresh air. interchangeable with size of rocks inserted

plant life provides fresh air and helps to block the warm from entering

dried palm leaves allow privacy, circulation and ventilation

