

AKALYPTOS Ippodromiou str

Eleni Antoniadou \_ Athina Athiana \_ Christina Zafiriou-Hatziki-riakou \_ Maria-Eleni Karavioti \_ Lydia Kontozoglou \_ Maria Pa-pakonstantinou \_ Georgia Petri \_ Martha Seitanidou \_ Anastasia Voutsas \_ Areti Tsagkouri \_ Georgios Vlachodimos (volunteer)

40.22 architects Anastasia Papadopoulou, dr. Architect AUTH, MLA AUTH Vanessa Tsakalidou, dr. Architect AUTH, M.Arch The Bartlett UCL Collaborator: Pantelis Petridis, dipl. Architect AUTH

| analysis

| accessibility

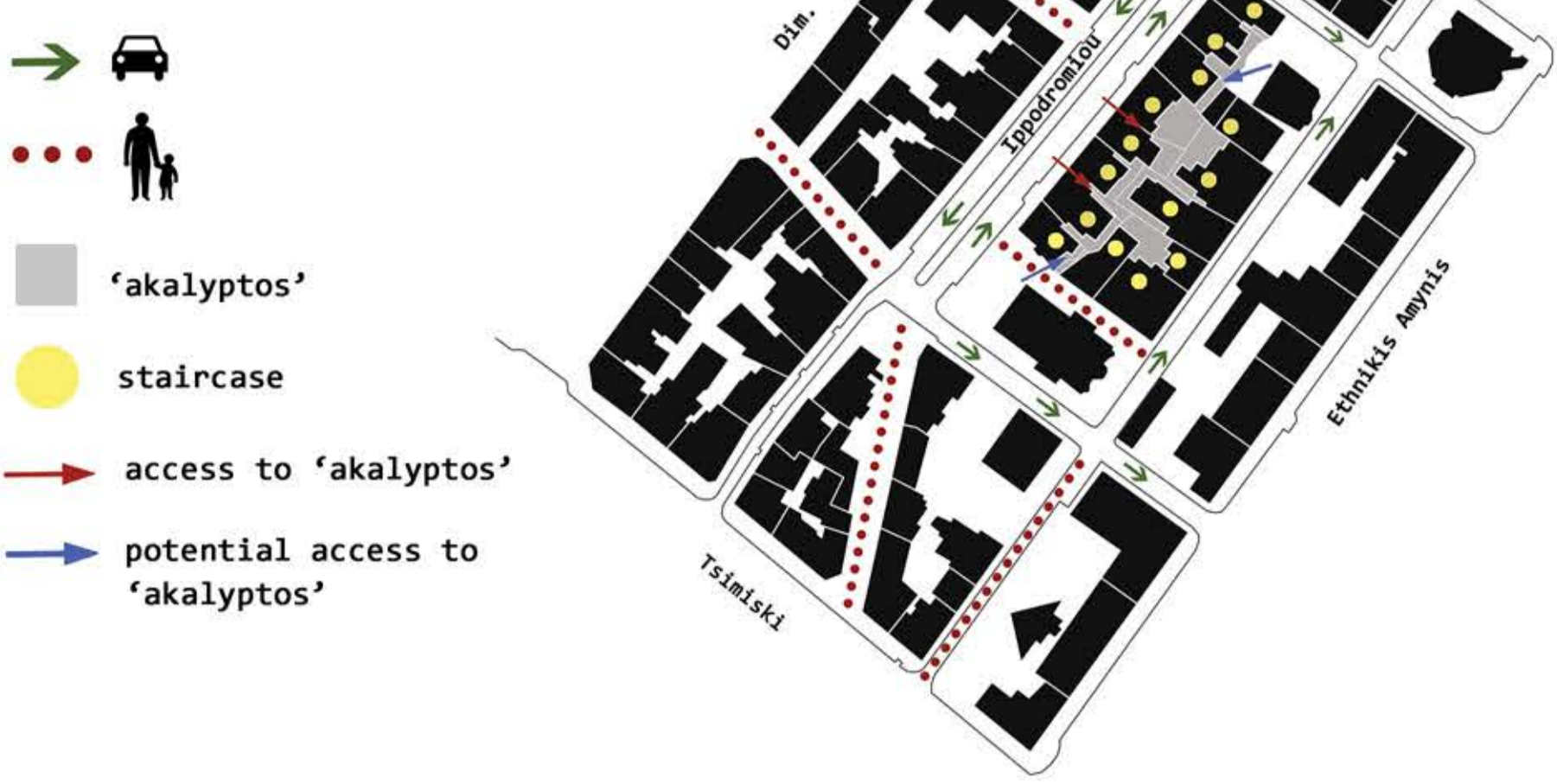

| identity of "akalyptos"



| levels

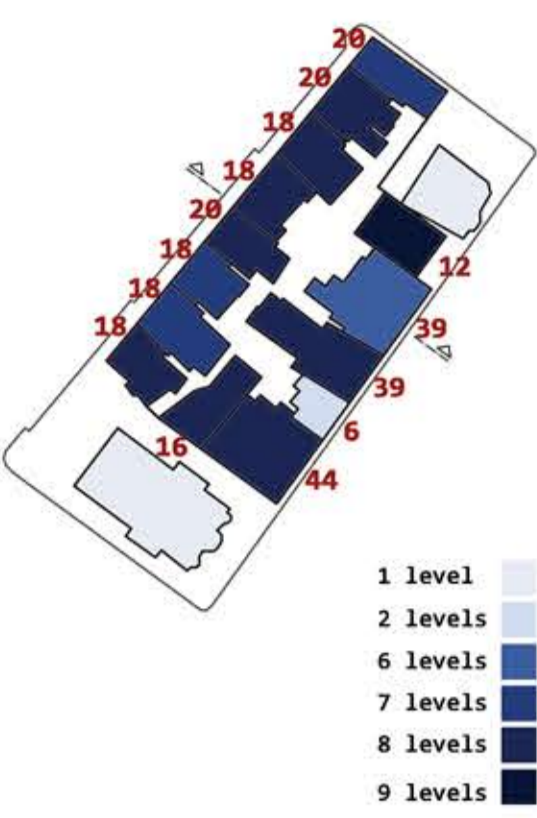

| number of apartments

14 multi-residence buildings //  
306 apartments //  
918 people approximately

| materiality



| ground floor uses

- Residential Plots
- Business/Commerce
- Churches/Monuments
- Sport Activities
- Abandoned/Without Use
- Bad Condition
- Moderate Condition
- Good Condition
- Hairdresser
- Professional Office
- Doctor
- Cultural center
- Photography center
- Various shops
- Akalyptos
- Garage
- Residence Entrance
- Real Estate
- Shops
- Book And Print Stores
- Laundry/Dry Cleaning
- Sport Activities
- Churches
- Abandoned or For Rent

| problems identified

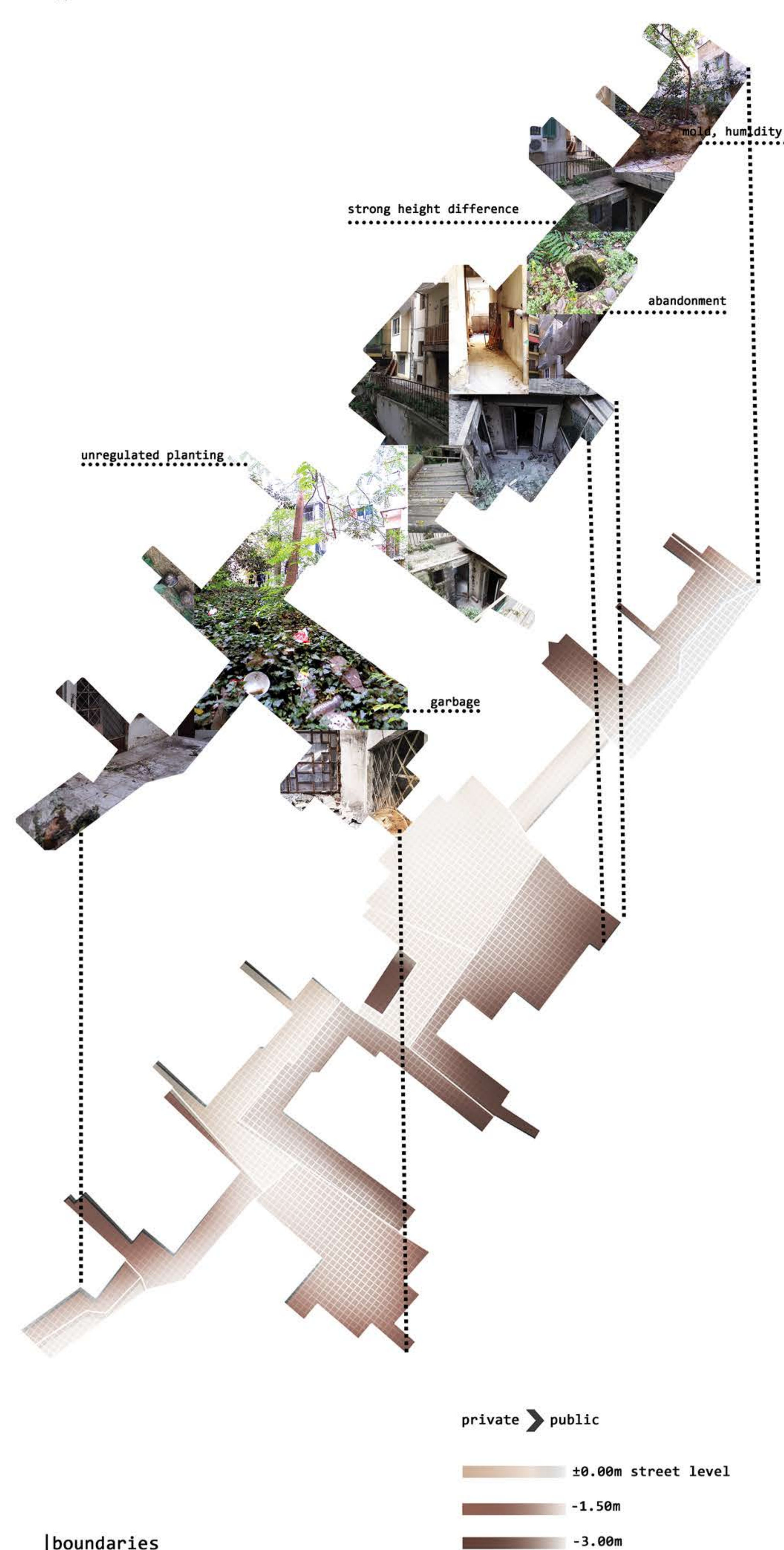

| shadowing

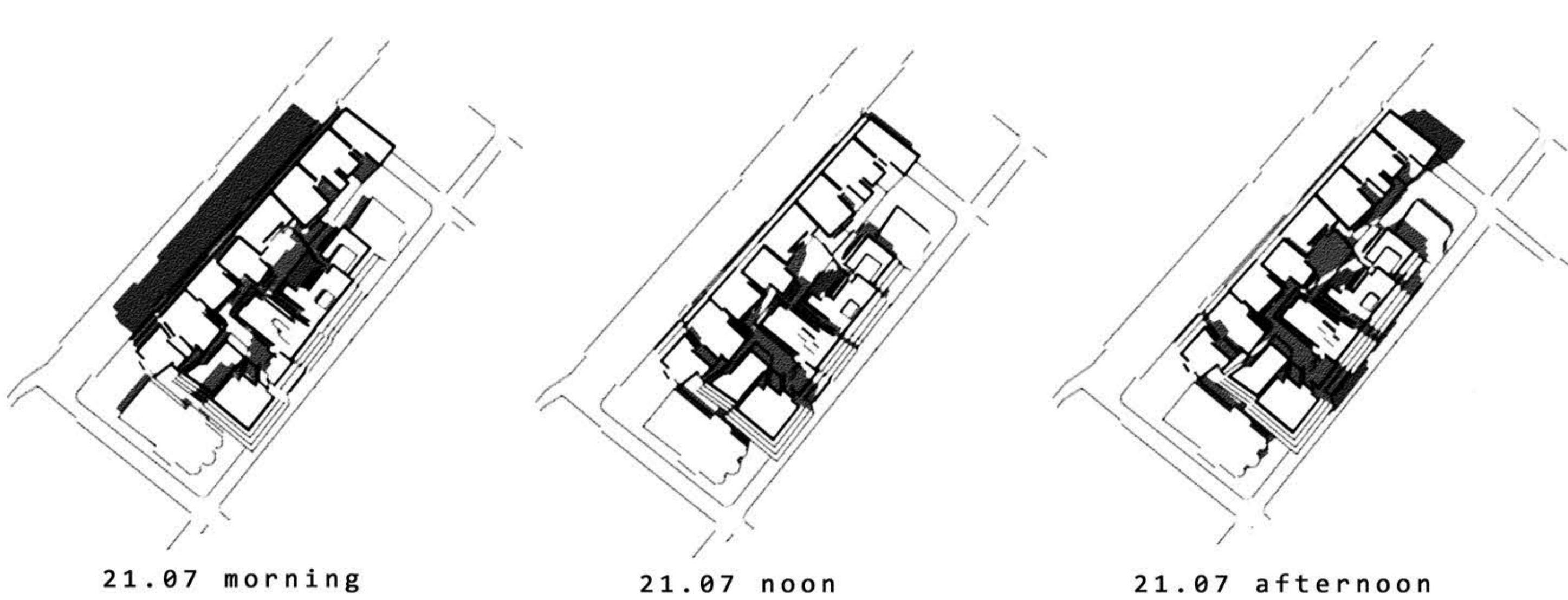

| plan of plants

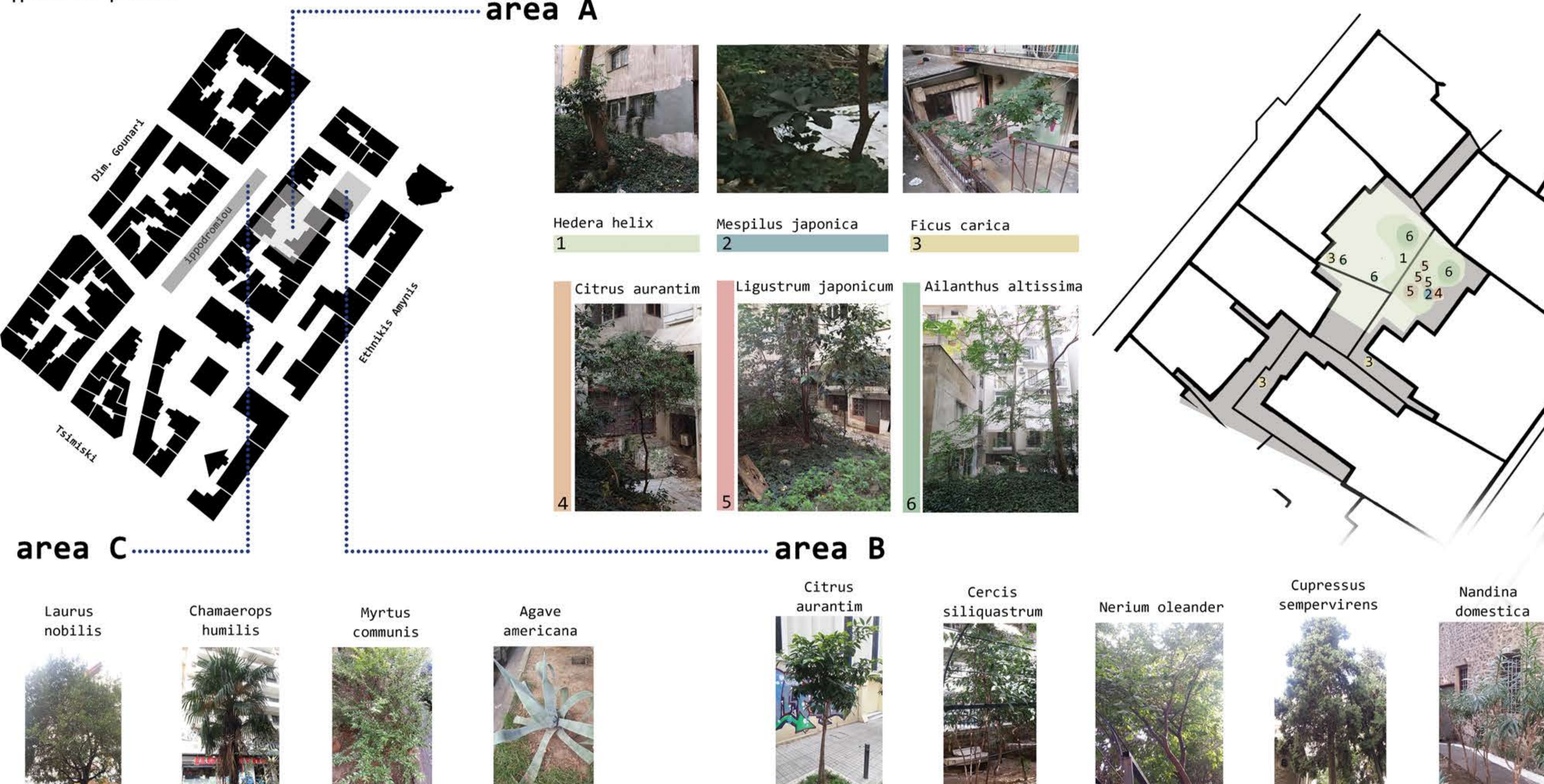

| from mess to mesh



The main idea of our proposal was inspired by the diversity of this particular neighborhood. Our goal was to create a space that everyone can use, from the elder people to the children. First and foremost we wanted to design a green space which will connect this enclosed area with the city, while at the same time we wanted to respect and protect the privacy of the people that inhabit this environment.

Taking into account the socio-economic situation of the neighborhood and considering thoroughly the environmental aspect, the shadowing and the vegetation that thrives in this wildscape of Thessaloniki, we decided to reclaim the "akalyptos" and transform it into a small park, flexible to host different scenarios of uses. We noticed the existence of 3 main levels of circulation and we decided to connect these height differences, while trying to follow the landscape that was offered. We proposed a new pixelated fabric, as a mosaic (a familiar pattern to the inhabitants of Thessaloniki) that would float over the existing area and incorporate all desired uses.

We chose to use eco-friendly materials in the "akalyptos", such as wood, gravel, soil for the common spaces. Re-used metal meshes and elements form the structure of our pixelated fabric which forms the basic promenade, the sitting areas and furniture. Vegetation is an important part of our proposal. Trees, bushes and mosses (ailanthus altissima, cercis siliquastrum, buxus sempervirens, mahonia aquifolium, delphinium ajacis, portulaca grandiflora, etc) fill the green spaces that are scattered strategically in the overall space. In the main area, the trees selected offer their shadowing in the summer and a warm welcoming in the akalyptos. The bushes and mosses provide color and fragrance in the environment, adding to the quality of space.

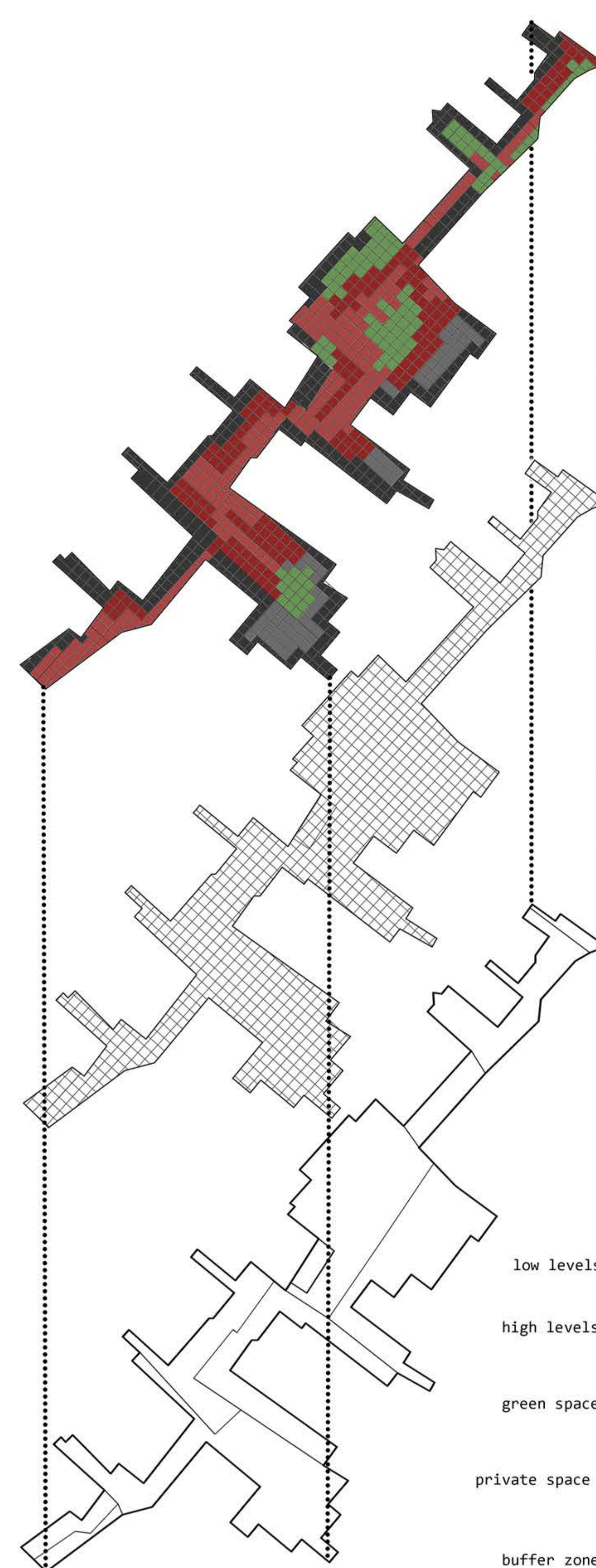

| masterplan



- .tree
  - Ailanthus altissima
  - Cercis siliquastrum
- .bush
  - mahonia aquifolium
  - buxus sempervirens

- .flooring
  - cast material
  - deck
  - grass
  - mosses
  - ivies

| vegetation

- .tree
  - Ailanthus altissima height : 25-30m width: 10m blooming: april-may
  - Cercis siliquastrum height : 10m width: 7m blooming: march-april

- .bush
  - Buxus sempervirens height : 1m width: <1m
  - Mahonia aquifolium height : 3m width: 1-2m blooming: march-april

- .MOSS
  - Cyclamen persicum height: 0.50m width: 0.20-0.50m blooming: winter-spring
  - Delphinium ajacis height : 1m blooming : may-june
  - Portulaca grandiflora height : 0.10-0.15m width: 0.50m blooming : summer
  - Callistephus chinensis height : 0.60-0.90m width: height

- .ivy
  - Clematis jackmanii height : 4-5m blooming: june-september
  - Parthenocissus tricuspidata height : 8-10m blooming: june-july
  - Rosmarinus officinalis prostratus height : 0.60m width: 1.50-1.80m

