

SCHOOL YARD ON THE BLUE AXIS

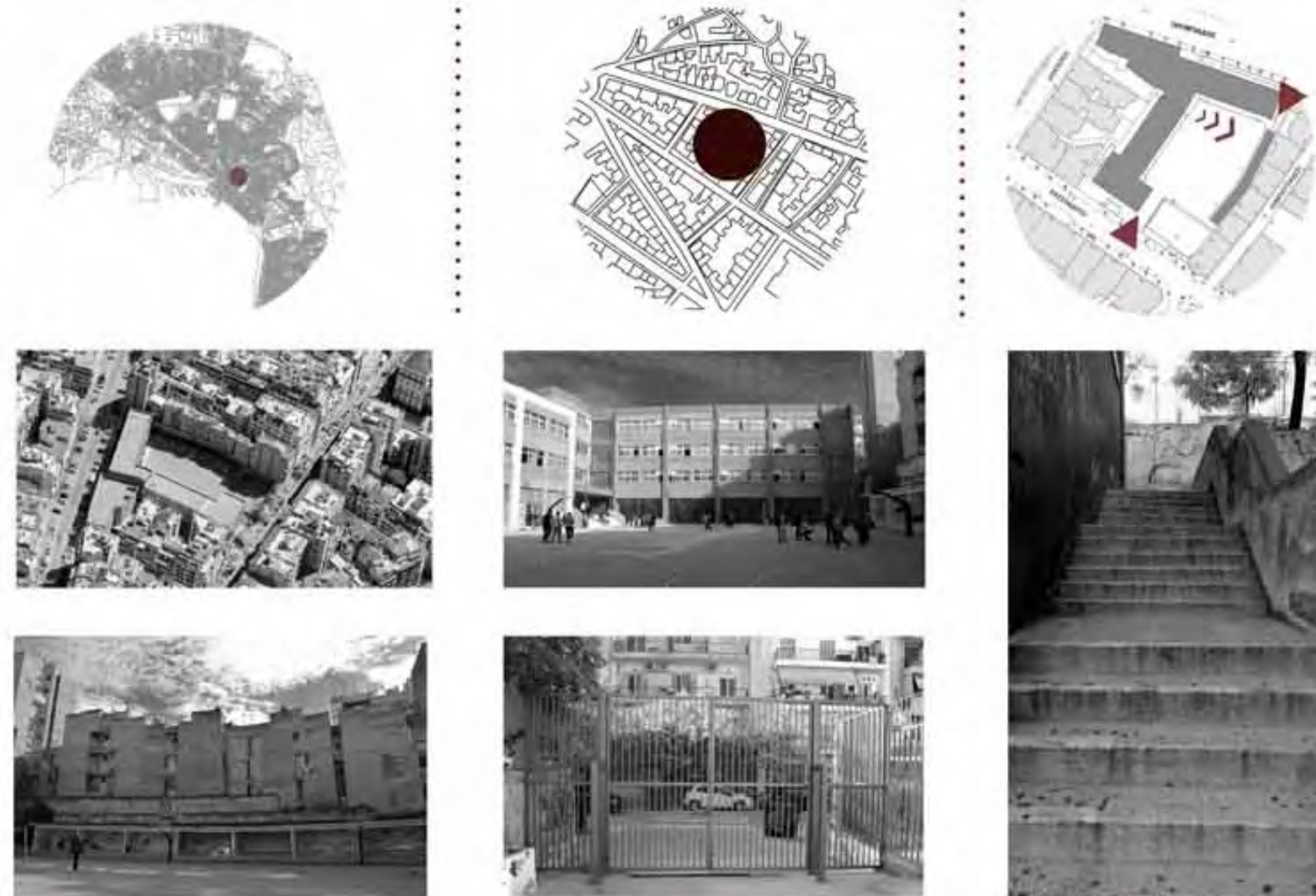

- LOCATION of the school // surroundings
- ACCESSES from Kassandrou and Olympiados street
- ACCESS from the school to the construction
- The Blind Wall
- The school yard

Goal of the project was to propose a new design of the backyard of a school building which includes two junior high and one high school. The building is located in the city center and this is the reason why the urban net is too dense there. The main problem which we had to face was a kind of "blind" walls of the neighbor buildings, some of them reaching almost nine floors height. Apart from this, the schoolyard was already a problematic area because of the different levels, a big plot with a row of railings in the front facade and a row of "cells" which are creating smaller sitting areas and they are poorly designed, creating a hostile and low quality space. The size of the schoolyard is insufficient for this amount of students who need a much greater place to work out, play, rest and communicate. One of our major principles was to create an extra vertical construction in front of the "blind" wall, so as not to reduce any more of the free space which already exists. Another one principle was to multiply the green areas while raising the aesthetic level of the schoolyard. The green areas were raised the aesthetic level of the schoolyard. The green areas were raised the aesthetic level of the schoolyard. The green areas were raised the aesthetic level of the schoolyard.

The whole design process was based in a grid which is developed across the entire front, reaching almost the highest level of the buildings behind. Finally, the dimensions of the grid were 3x3m, but there was the option to change the initial grid in smaller or bigger parts. Also, it was a common perspective to leave the ground level of the construction free, due to the goal we set to increase the element of nature, upon the grid are hosted several uses that intrigue the users to explore it, while there are stairs, routes, rest areas and plants that make the construction not only structural but also interesting and interactive. After setting the main principles we were divided into three groups of four people each to create a different aspect of dealing with the grid.

a.Group 1: Dancing Walls
Aiming to bring a more interactive dimension to the stereotypical greek schoolyard, we focused on creating a constantly changing and perpetually moving facade. The deeper goal beneath this movement is to transform a passive "container" of human activities to an active and dynamic structure affected by them. As a result, the interest of the users is constantly aroused. Moreover, the mobile panels and stairs are placed in the front plane, whereas the static elements are set in the back plane, so as to enhance the factor of movement. Apart from saving the needs of a schoolyard, the construction is extended to the adjacent roads to also act as a connecting "bridge". Regarding the green element, there is a fence in the back plane designed to aid the growth of the climbing plants and create a green home around the construction. In conclusion, all over the construction there are open rooms of various forms to host numerous activities, emphasizing the ever-changing concept of the design.

b.Group 2: Re- Forest
Our actions were to break the grid by adding more vertical elements to reinforce the illusion of the forest, creating bigger open rooms which are hosting several activities, decomposing the strict boundaries of the grid and supporting the idea of bio-recycling and composting as a main goal of an active educational eco-friendly program. Each child produces themselves fertilizer by bringing bio-disposal rubbish into the suitable bins (composters). This fertilizer will be used to enhance the growth of their personal plants. The bio-bins and the plants would be hosted under and above the grid construction respectively. Finally, we added panels pierced with an abstract pattern in order to play with shadow and light between the routes.

c.Group 3: Fly me to the farm... and let me play among the plants
The main characteristic of this version is the gardens. We want to enhance a more interactive relationship with the students by making them farmers. In addition to the vertical plantations on the grid, this proposal creates green spaces both on the yard and the metal construction, thus creating the opportunity for the student to learn about cultivation and watch their own plants grow through the school year. In order to expand this metal grid on the yard, we used the footprint of the facing buildings' skyline on the yard ground and the section.

ALTERNATIVE proposals

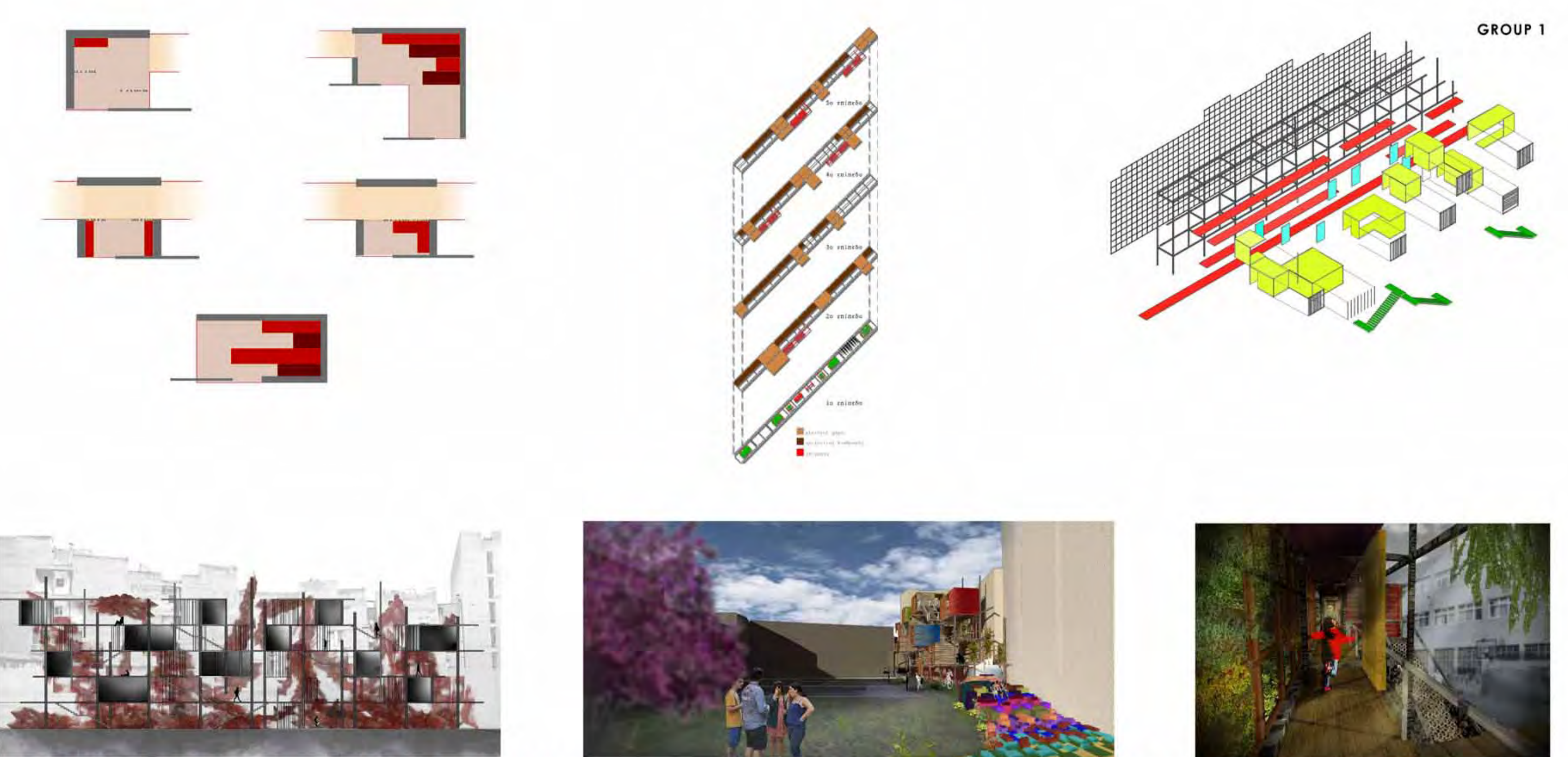

GROUP 1

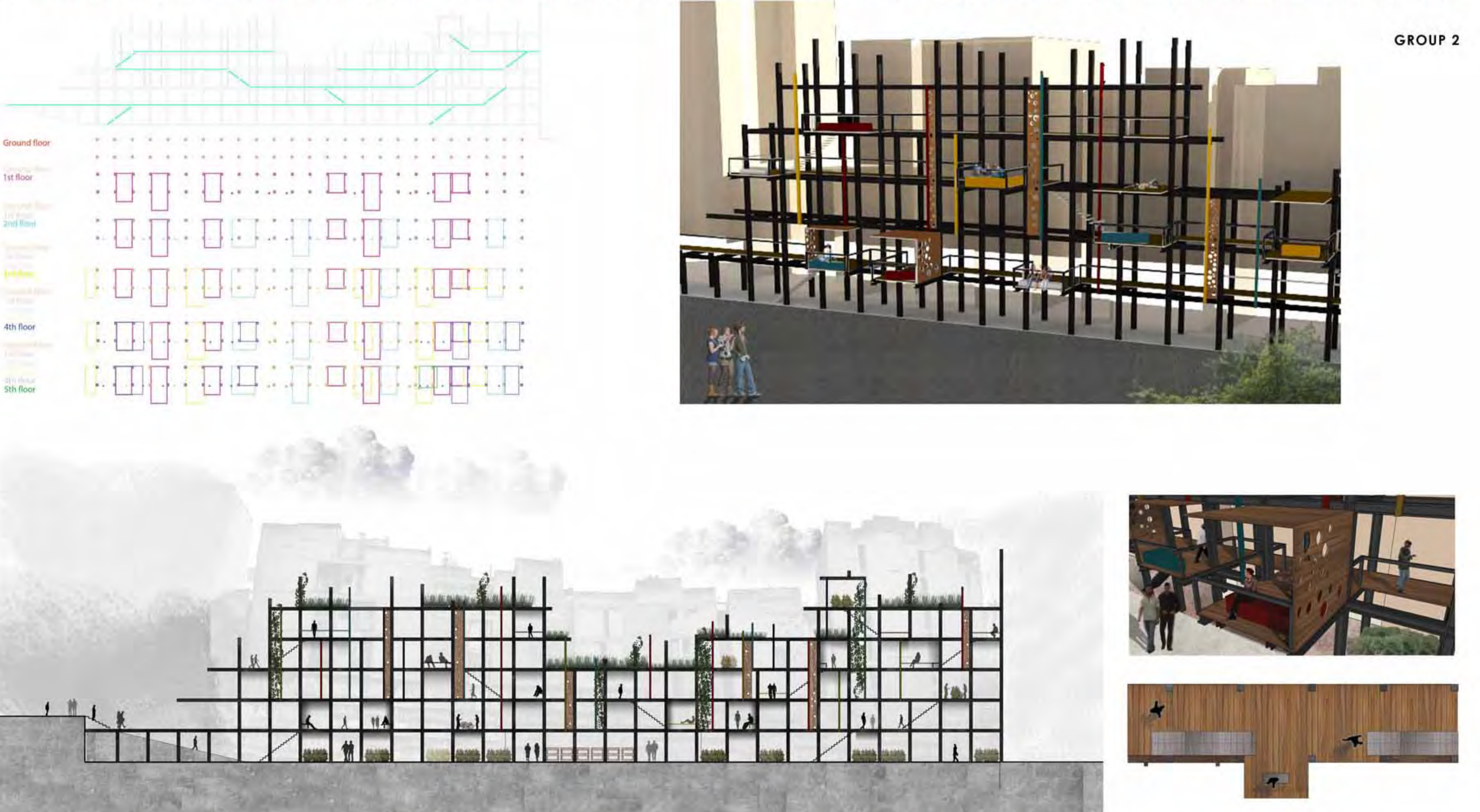

GROUP 2



GROUP 3

WORKSHOP 2_ Public School

Tutors:
Prodromos Nikiforidis, Bernard Cuomo, Greece

Location:
17 Kassandrou Street, Thessaloniki

PARTICIPANTS:

Kourkopoulos Letteris, Panagiotidou Vasiliki, Shiamaris Angelos, Gkontra Konstantina, Eleutherochorinou Maria, Papanikolaou Artemis, Sapka Eirini, Varvatuou Karina, Papakonstantinou Alexia, Stefanidou Mariliza, Symeonidou Chara.

ECOWEEK 2015

... habits change ... climate change